



*Inspiring Trust, Assuring Safe & Nutritious Food*  
Ministry of Health and Family Welfare, Government of India

**REQUEST FOR PROPOSAL FOR  
CREATION OF INTERNATIONAL  
TRAINING CENTRE FOR FOOD SAFETY  
AND APPLIED NUTRITION AT 2<sup>nd</sup>  
FLOOR, PILOT TEST HOUSE, EXPORT  
INSPECTION AGENCY, MIDC AREA,  
ANDHERI (EAST), MUMBAI-400 069**

F. No.11023/07/2017-QA

**FOOD SAFETY AND STANDARDS AUTHORITY OF INDIA**  
**MINISTRY OF HEALTH AND FAMILY WELFARE**  
**3RD FLOOR, FDA BHAWAN, KOTLA ROAD,**  
**NEW DELHI-110002.**

Dated, the 28<sup>th</sup> June, 2018

**TENDER NOTICE**

**REQUEST FOR PROPOSAL FOR CREATION OF INTERNATIONAL TRAINING CENTRE FOR FOOD SAFETY AND APPLIED NUTRITION AT 2<sup>nd</sup> FLOOR PILOT TEST HOUSE, EXPORT INSPECTION AGENCY, MIDC AREA, ANDHERI (EAST), MUMBAI-400 069**

FSSAI, functioning under the Ministry of Health & Family Welfare in association with Export Inspection Council (EIC) under the Ministry of Commerce & Industry jointly and in collaboration with Global Food Safety Partnership (GFSP) intend to create ready to use International Training Centre for "Food Safety and Applied Nutrition" (ITC-FSAN) at E-3, Pilot Test House (2<sup>nd</sup> Floor) of Export Inspection Agency, located in MIDC area, Andheri (East), Mumbai-400 069.

2. Accordingly, Food Safety and Standards Authority of India (FSSAI) invites sealed Tenders from the reputed & experienced agency / firms registered with CPWD / PWD/ or any Government Organizations for undertaking the construction / civil work in Mumbai for creation of International Training Centre by carrying out jobs like interior work after completion of civil job which includes wooden paneling, flexi partition, air-conditioning, audio-video system, supply of furniture and fixtures & allied misc work with approx 450 sqm covered area at 2<sup>nd</sup> Floor, Pilot Test House, Export Inspection Agency, MIDC Area, Andheri (E), Mumbai-400 069 in compliance of terms and conditions stipulated in the tender document.

3. The tender document is available on the FSSAI website and CPP Portal. The duly filled in Tender Document with relevant supporting documents may be submitted on or before **20<sup>th</sup> July 2018 by 1500 hrs** addressed to Assistant Director (QA), FSSAI, Room No.304, 3<sup>rd</sup> Floor, FDA Bhawan, Kotla Road, New Delhi 110002 along with demand draft/banker's cheque/Fixed Deposit Receipt/Bank Guarantee for Rs. 5,00,000/- (Rupees Five Lakhs Only) (Non-bearing interest) as Earnest Money Deposit (EMD). The Demand Draft / Pay order towards EMD should be in favour of Senior Accounts Officer, FSSAI payable at New Delhi.

4. Tender document (non-transferable) containing detailed specifications, terms & conditions can also be obtained from FSSAI on payment of cost of tender/document Rs.500/- (non-refundable) in the form of Demand Draft/Pay order drawn on any Nationalized/scheduled commercial Bank in favour of **Senior Accounts Officer, FSSAI** payable at **New Delhi** or in cash. Alternatively, the tender document can be downloaded from FSSAI **website: [www.fssai.gov.in](http://www.fssai.gov.in) and [www.eprocure.gov.in](http://www.eprocure.gov.in)** without any payment towards cost of the tender document

5. **Address for communication:** Assistant Director (QA), Food Safety and Standards Authority of India (FSSAI), 3<sup>rd</sup> Floor, FDA Bhawan, Kotla Road, New Delhi. -110002

6. **Name/Designation of contact person** : Nilesh Kumar Ojha,  
Asstt. Director (Quality Assurance)

7. **Telephone No.** : 011- 23237417

Sd/-  
Advisor (QA)  
FOOD SAFETY AND STANDARDS AUTHORITY OF INDIA



**REQUEST FOR PROPOSAL FOR CREATION OF INTERNATIONAL TRAINING CENTRE FOR FOOD SAFETY AND APPLIED NUTRITION AT 2<sup>nd</sup> FLOOR PILOT TEST HOUSE, EXPORT INSPECTION AGENCY, MIDC AREA, ANDHERI (EAST), MUMBAI-400 069**

**1. SUBMISSION OF BID:**

1.1 a) Submission, acceptance and rejection: - A tender in sealed cover super-scribing "Bid for International Training Centre" should reach in the office of Assistant Director (QA), Food Safety and Standards Authority of India, 3<sup>rd</sup> Floor, FDA Bhawan, Kotla Road, New Delhi-110002 on or before **20<sup>th</sup> July 2018** by **1500 hrs**.

b) The tender will be submitted in two parts as under: -

(i) Technical Bid – Technical Bid consisting of all technical details along with EMD, Bank Solvency Certificate and commercial terms and conditions, and

(ii) Financial Bid – Financial Bid indicating item-wise price for the items mentioned in the technical bid.

Note: The technical bid and the financial bid should be sealed by the bidder in separate covers duly super scribed (as "Technical Bid" or "Financial Bid" as the case may be) and both these sealed covers are to be put in a bigger cover which should also be sealed and duly super-scribed (as Tender Documents in response to Tender Notice No. **02/2018-19** dated **28<sup>th</sup> June 2018** for carrying out the work for creation of ITC-FSAN on 2<sup>nd</sup> floor of the Pilot Test House, MIDC Area, Andheri (E), Mumbai)

c) Tenders which are not complete in all respects are liable to be rejected.

d) While submitting the tender, the tenderers will be deemed to have read, understood and accepted all the terms and conditions stated in the tender documents. Any doubts or clarifications with regard to the interpretation of the terms and conditions stipulated in the Tender Enquiry, may be got clarified from FSSAI HQrs mentioned above at least 2 working days before the date of pre-bid meeting.

2. Non-transferability: This tender is non-transferable.

**3. Bidder's Eligibility Criteria (BEC)**

3.1 **Experience:** Bidders [agency / firms registered with CPWD / PWD/ or any Government Organizations for undertaking the construction / civil work are required to submit documentary proof of work orders of Three works of Rs. 75 Lakh each or two works of Rs. 1.25 cr each or one composite work of building of Rs. 2.5 cr. The composite work of building means Civil Building work including either internal electrification or one of the E&M services (i.e. HVAC or Lift or Electrical Sub Station or DG Set or other similar items) under one agreement during the last five years. The date of issue of this tender will be the relevant date for reckoning of period.

### 3.2 **Financial Criteria:**

- 3.2.1 Annual Turn Over: The Financial Statement (i.e. Trading & Profit and Loss A/c and Balance Sheet/ITR etc) in support of showing turnover of the firm with minimum Rs. 250 lakhs (Rs.2.50 crore) or more p.a. for the last/previous 03 financial years (a) 2015-16, (b) 2016-17, (c) 2017-18.
- 3.2.2 The tenderers shall have to submit the documentary proof in support of above requirement by submitting financial statements/ITR/CA Certificate etc. The bids not meeting the above requirements of Tender documents entirely and/or not accompanied by necessary supportive documents for turnover shall be summarily rejected & shall not be considered for detailed evaluation.

### 4. **Scope / Description of Work**

- 4.1 Creation of ready to use International Training Centre for “Food Safety and Applied Nutrition” at E-3, Pilot Test House (2<sup>nd</sup> Floor) of Export Inspection Agency, located in MIDC area, Andheri (East), Mumbai-400 069. All the civil and essential supportive work like complete interior finishing, installations of ultra-modern/latest available technology of VRF air-conditioning system (Cassette Type) being highly energy efficient and also Split Air-conditioners (100% inverter technology with cooling capacity only), digital audio/video system complete, Furniture and Fixtures, LED lights of different category/wattage and allied various miscellaneous jobs **to make it ready to use on turn-key basis are required to be carried out by the selected agency as per detailed scope of work/BOQ at Annexure – 1 and lay out plan at Annexure 2.**
5. **Technical Bid :** Technical Bid consists of all technical details along with commercial terms and conditions. This bid also covers minimum eligibility criteria and required documents as mentioned below. **Further, it is made clear that no part of financial bid should be reflected or disclosed in technical bid in any manner. If so found, the tender will be summarily rejected by FSSAI.**
- 5.1 **Tender fees:** Cost of tender fee [if purchased from FSSAI] is Rs.500/- (non-refundable) in the form of Demand draft/Pay order drawn on any Nationalized Bank in favour of Senior Accounts Officer, FSSAI, payable at New Delhi 110002
- 5.2 **Earnest Money Deposit (EMD)/Bid Security:** Earnest Money Deposit is for **Rs.5,00,000/- (Rupees Five Lakhs Only)** (non-bearing interest). The EMD shall be paid in the form of demand draft/banker’s cheque/Fixed Deposit Receipt/Bank Guarantee issued by a nationalized bank/Scheduled Commercial Bank in an acceptable form in favour of **Senior Accounts Officer, FSSAI** payable at **New Delhi.**
- 5.3 Tender offers received without EMD shall be rejected straightway and will not be considered. EMD of tendering agency who submits the sealed quotation but withdraw the same before expiry of the tender validity date may be forfeited at the discretion of FSSAI.
- 5.4 **Firm’s Registration:** Bidder must be registered for GST and Income tax i.e. having GST /PAN Number in Mumbai. (Attach supportive document viz copy of Regn).
- 5.5 The person signing the tender document on behalf of the agency, shall attach with the tender an authorisation, duly executed, stating that he has the authority to bind in all the matters pertaining to the contract, including the arbitration clause.
- 5.6 The bidding firm/agency/company should be an Indian Firm/Agency/Company of Indian origin having been incorporated/in existence for the minimum period of five years as on date of tender document. (attach supportive documentary proof indicating existence date).

- 5.7 The bidding establishments should be a registered with CPWD / PWD/ or any Government Organizations for undertaking the construction / civil work (attach supporting document as proof).
- 5.8 The bidding firm/agency/company must have successfully done/completed three works of Rs. 75 Lakh each or two works of Rs. 1.25 cr each or one composite work of building of Rs. 2.5 cr under one agreement during the last five years. The composite work of building means Civil Building work including either internal electrification or one of the E&M services (i.e. HVAC or Lift or Electrical Sub Station or DG Set or other similar items). The date of issue of this tender will be the relevant date for reckoning of period. [Please submit documentary proof of the said work orders].
- 5.9 The agency and its associated subsidiaries should not have been blacklisted by any agency or involved in any pending government investigation directly for corruption or unfair trade practices etc (Separate undertaking to be submitted by the bidder).
- 5.10 A check list for submission of the relevant documents is enclosed at **Annexure -3**. Bidders are requested to ensure the compliance as per check list while submitting the offer.

### Site Visit and Pre-bid Meeting

6. **Site visit:** The probable bidders are advised to visit the site of work to assess the proposed requirement/job of work, with the permission of the Joint Director, EIC, PTH, Mumbai. Tele : 022-28397998

6.1 **Pre-Bid Meeting:** Pre-bid meeting will be held on **06<sup>th</sup> July 2018** at **1100hrs** in Conference Hall of Food Safety and Standards Authority of India, FDA Bhawan, Kotla Road, New Delhi-110002 for clarification/discussion on the proposed work. Interested bidders may attend the same.

### 7. Financial Bid

7.1 Financial bid should **quote Unit rate of description of goods** (in quantity) in the format, **Annexure – 4** enclosed, figures in Indian rupees (in words also). Incomplete bids will be rejected summarily.

7.2 Rates quoted shall be excluding of all statutory duties and taxes etc. as applicable. Price quoted shall be firm and any variation in rates, prices or terms during the validity of the offer may lead to forfeiture of the EMD. All Statutory duties and taxes etc. as applicable may be quoted separately and **in case no specific taxes are mentioned the prices quoted shall be considered as if there is no tax on that particular item/work.**

7.3 All warranty and guarantee attached with supply items (Branded Furniture, AC/VRF System, AV system etc.) from the OEM/Dealer shall be transferred to FSSAI/EIC jointly in writing and original papers from OEM/Dealer.

### 8. Documents

Bid documents may be submitted in the agency's letter head/Covering letter containing all the documents listed in the check list at **Annexure 3**.

## 9. Terms and Conditions

- 9.1. **Law:** The Contract shall be considered and made in accordance with the laws of the Republic of India. The contract shall be governed by and interpreted in accordance with the laws of the Republic of India.
- 9.2. **Effective Date of the Contract:** The contract shall come into effect on the date of signatures of both the parties on the contract (Effective Date) and shall remain valid until the completion of the obligations of the parties under the contract. The deliveries and supplies and performance of the services shall commence from the effective date of the contract. All the specified works and services, supply of items etc; shall be completed within **120 days** from the date of effective date of contract.
- 9.3. **Penalty for use of Undue influence:** The Seller/selected bidder undertakes that he has not given, offered or promised to give, directly or indirectly, any gift, consideration, reward, commission, fees, brokerage or inducement to any person in service of the Buyer or otherwise in procuring the Contracts or forbearing to do or for having done or forborne to do any act in relation to the obtaining or execution of the present Contract or any other Contract with the Government of India for showing or forbearing to show favour or disfavour to any person in relation to the present Contract or any other Contract with the Government of India. Any breach of the aforesaid undertaking by the Seller or any one employed by him or acting on his behalf (whether with or without the knowledge of the Seller) or the commission of any offers by the Seller or anyone employed by him or acting on his behalf, as defined in Chapter IX of the Indian Penal Code, 1860 or the Prevention of Corruption Act, 1986 or any other Act enacted for the prevention of corruption shall entitle the Buyer i.e. FSSAI to cancel the contract and all or any other contracts with the Seller and recover from the Seller the amount of any loss arising from such cancellation. A decision of the Buyer or his nominee to the effect that a breach of the undertaking had been committed shall be final and binding on the Seller. Giving or offering of any gift, bribe or inducement or any attempt at any such act on behalf of the Seller towards any officer/employee of the Buyer or to any other person in a position to influence any officer/employee of the Buyer for showing any favour in relation to this or any other contract, shall render the Seller to such liability/ penalty as the Buyer may deem proper, including but not limited to termination of the contract, imposition of penal damages, forfeiture of the Bank Guarantee and refund of the amounts paid by the Buyer.
- 9.4. **Access to Books of Accounts:** In case it is found to the satisfaction of the Buyer that the Seller has engaged an Agent or paid commission or influenced any person to obtain the contract as described in clauses relating to Agents/Agency Commission and penalty for use of undue influence, the Seller, on a specific request of the Buyer, shall provide necessary information/ inspection of the relevant financial documents/information.
- 9.5. **Non-disclosure of Contract documents:** Except with the written consent of the Buyer/Seller, other party shall not disclose the contract or any provision, specification, plan, design, pattern, sample or information thereof to any third party except where required by the law of the land.
- 9.6. **Liquidated Damages:** In the event of the Seller's failure to submit the Bonds, Guarantees and Documents, supply the goods/items/services and conduct trials, installation of equipment, training, etc as specified in this contract, the Buyer may, at his discretion, withhold any payment until the completion of the contract. The BUYER i.e. FSSAI may also deduct from the SELLER/Selected Bidder as agreed, liquidated damages to the sum of 0.5% of the contract price of the delayed/undelivered stores/services mentioned above for every week of delay or part of a week, subject to the maximum value of the Liquidated Damages being not higher than 10% of the value of delayed stores/works/services.



## 10. **Bid Opening**

- 10.1 On the date and time mentioned in the tender notice, Technical bid will be opened on **20<sup>th</sup> July 2018 at 1530 hrs** at 3<sup>rd</sup> Floor, FDA Bhawan, New Delhi-110002.
- 10.2 Authorized representative(s) of the tenderers may attend the meeting, if they wish to. The authorized representative must be competent and empowered to settle all technical and commercial issues, if required.

## 11. **EVALUATION CRITERIA:**

- 11.1 Prior to the financial evaluation of bids, FSSAI will determine whether each bid is substantially responsive to the requirement of bidding documents. Eligibility of tenderer will be based on proof of past experience, financial capability, resource availability, which should form the technical offer by fulfilling the requisite qualifying requirement as mentioned above. The technical offer of the firm would be evaluated by the duly constituted Evaluation Committee. The financial/commercial offers will be opened only in respect of the bidders who qualify the technical bid requirements as per the tender details.
- 11.2 No error, overwriting / correction shall be permissible unless attested under the signature of the bidder with date and seal.
- 11.3 The technical bid not meeting the minimum requirements as per the tender documents shall be rejected and their financial bids will be returned unopened.
- 11.4 Technically qualified bidders may be informed by email. The bidder who qualifies at the technical evaluation stage shall only be called for opening of financial bids. Client shall intimate the bidders, the time/venue for the financial Bid opening through written communication /or email and uploading the same on the concerned websites.
12. **Validity of Tender:** Tender shall be valid for acceptance for a period not less than **180 days** after tender opening date.

## 13. **Award of Contract:**

- 13.1 FSSAI will award the contract to the tenderer whose tender has been determined to be substantially responsive. By the process of evaluation of technical bids and financial bids, the Lowest Bid will be decided upon the lowest price quoted by the particular bidder as per the Commercial/Price Bid Performa Annexed to this Tender enquiry.
- 13.2 If there is a discrepancy between the unit price and the total price that is obtained by multiplying the unit price and quantity, the unit price will prevail and the total price will be corrected. If there is a discrepancy between words and figures, the amount in words will prevail for calculation of price.
- 13.3 The successful bidder shall be required to furnish a Performance Security (an amount of 10 % of the total value of the contract) in the form of Account Payee DD / Bankers cheque/Fixed Deposit receipt/Bank Guarantee from a Commercial bank in an acceptable form **(Annexure- 5)**.
- 13.4 The Performance Security shall remain valid for a period of sixty days beyond the date of completion of all contractual obligations.

14. **Arbitration:** All disputes or differences arising out of or in connection with the Contract shall be settled by bilateral discussions. Any dispute, disagreement or question arising out of or relating to the Contract or relating to construction or performance, which cannot be settled amicably, may be resolved through arbitration. Appointment of Arbitrator shall be made by mutual consent, taling which Arbitrator shall be appointed under Arbitration Act/Min of Law & Justice.
15. **Termination of Contract:** The Buyer shall have the right to terminate this Contract in part or in full in any of the following cases: -
- (a) The delivery of the material or required works and services is/are delayed for causes not attributable to Force Majeure for more than two week after the scheduled delivery/work/services.
- (b) The Contractor is declared bankrupt or becomes insolvent.
- (c) The completion of work is delayed due to causes of Force Majeure by more than two weeks provided Force Majeure clause is included in contract.
- (d) The Buyer/FSSAI has noticed that the selected agency/Contractor has utilised the services of any Indian/Foreign agent in getting this contract and paid any commission to such individual/company etc.
- (e) As per decision of the Arbitration Tribunal.
- (g) Non-compliance of applicable statutory obligations, as per law of land by seller/selected firm.
16. **Notices:** Any notice required or permitted by the contract shall be written in the English language and may be delivered personally or may be sent by FAX or registered pre-paid mail/airmail/e-mail, addressed to the last known address of the party to whom it is sent.
17. **Transfer and Sub-letting:** The Seller/Contractor has no right to give, bargain, sell, assign or sublet or otherwise dispose of the Contract or any part thereof, as well as to give or to let a third party take benefit or advantage of the present Contract or any part thereof.
18. **Amendments:** No provision of present Contract shall be changed or modified in any way (including this provision) either in whole or in part except by an instrument in writing made after the date of this Contract and signed on behalf of both the parties and which expressly states to amend the present Contract.
19. Failure of the successful bidder to comply with any of the requirements of above clauses shall constitute sufficient grounds for the annulment of the award and forfeiture of Bid Security.
20. **Payment Terms** : The payment to the selected Contractor will be made as per following schedule: -
- (a) 30% Advance of total cost- against submission of Bank Guarantee or Fixed Deposit in favour of Sr. Accounts Officer, FSSAI of an equivalent amount. This will be in addition to PBG @10% of the contract value.
- (b) After completion of approx 50% work as per given specifications/details within the stipulated time frame and to the satisfaction of buyer i.e. FSSAI; the 30% advance bank guarantee/Fixed Deposit/DD will be released/returned after making payment.
- (c) 20% on completion of approx 75% work



(d) and the balance 50% - on completion of entire works and Services/infrastructure as specified & and removal of all items/leftovers from site subject to satisfaction of the buyer.

**However, the selected agency shall be required to submit an indemnity bond on Rs.100/- e-stamp paper giving undertaking/guarantee for providing assurance on the entire works/services/supplied items etc; done under this RFP for a period of one year from the date of submission of final bill. In addition, a sum equivalent to 2.5% of the total contract value shall be remitted in favour of Sr Accounts Officer, FSSAI in the form of Bank Guarantee/Demand Draft/Fixed Deposit as token of support for the guarantee period. In case the selected agency fails to discharge its committed liability for any reason, the defect will be removed by FSSAI on its own and the amount deposited shall be forfeited in addition to Legal Course of affairs as per law of land against the Indemnity submitted.**

## **21. Payment of Bills**

Paying Authority will be FSSAI, 3<sup>rd</sup> Floor, FDA Bhavan, New Delhi-110 002. The payment of bills will be made on submission ink-signed copy of bill/invoice, copy of supply order/contract, job completion certificate, performance bank guarantee in acceptable form, and details for electronic payment viz account holder's name, bank name, branch name and address, account type, account number, IFSC code, MICR code by the selected Contractor along with the bill

## **22. FORCE MAJEURE**

22.1 In the event of either party being rendered unable/helpless by Force Majeure to perform any obligation required by them under the contract, the relative obligation of the party affected by such Force Majeure shall be suspended for the period during which such cause lasts. It is clarified that in case, the Force Majeure event occurs due to negligence of agency, then the provisions of this clause shall not apply to the agency.

22.2 Upon the occurrence of such cause and upon its termination, the party alleging that it has been rendered unable/helpless as aforesaid thereby, shall notify to the other party in writing within 07 (Seven) days of the alleged beginning and ending thereof giving full particulars and satisfactory proof. If deliveries are suspended under Force Majeure conditions lasting for more than 2 (two) months, FSSAI shall have the option of cancelling this contract in whole or part at its discretion without any liability on its part.

## **23. APPLICABLE LAW AND JURISDICTION**

All matters connected with this work shall be governed by the Indian law both substantive and procedural, for the time being in force and shall be subject to the exclusive jurisdiction of Indian Courts at Delhi and/or Mumbai.

X-X-X-X

**CIVIL WORKS AT ITC-FSAN**

S.No.	Item/Description	Unit	Qty
<b>A</b>	<b>Civil Work</b>		
1	Demolishing of Brick Work manually/by mechanical means including stacking of serviceable material and disposal of unserviceable material from site as per direction of concerned official (a) Cement mortar	Cum	3
2	Demolishing/ Chipping of Existing Stone / Tiles from floor manually/ by mechanical means including disposal of unserviceable material & usable material to be stake at site as per direction.	Sqm	600
3	Removal of Malba by mechanical transport including loading, unloading and stacking at site for all lead and lift complete as per direction of concerned officer	Cum	14
4	Providing and laying in position Cement Concrete 1:4:8 (1cement : 4coarse sand :8 graded stone aggregate 20mm nominal size of Coarse Sand) excluding the cost of centering and shuttering.	Cum	20
5	Brick work with bricks of class designation 75 in Super structure in cement mortar 1:6 (1cement:6 coarse sand of zone-II)	Cum	5
6	Half brick masonry with bricks of class designation 75 in super structure above plinth level in cement mortar 1:4(1cement :4 coarse sand of zone-II)	Sqm	15
7	12 to 15mm cement plaster of mix ; 1:5( 1cement :5 fine sand of zone-IV ) including galvanized chicken wire mesh (24 gauge 12 mm size) to junctions of concrete and masonry work and other locations including cutting to required sizes, side laps of minimum 75 mm and fixing in position with galvanized iron wire nails, complete on ceiling or wherever required .	Sqm	40
8	Providing & fixing 18mm thick gang-saw cut, mirror polished, premoulded& pre-polished, machine cut for kitchen platform, vanity counter, window sills, facias, and similar location of required size, approved shade, colour& texture layed over 20mm thick base cement mortar 1:4 9 1 cement : 4 coarse sand), joints treated with white cement, mixed matching pigment, epoxy touch ups, including rubbing, curing, moulding& polishing to edges to give high gloss finish etc. complete at all levels. (a) Granite of any colour of shade, area of slab over 0.50 sqm	Sqm	5
9	Providing edge moulding to 18mm thick gang saw cut for kitchen platform, vanity counter, window sills, facias, and similar location of required size, including rubbing, moulding&polisging to edges to give high gloss finish etc complete at all levels  (a) Granite work	Mtr	5
10	Providing & filling of low density material – cinder etc to raise the floor for race way etc.	Cum	35

11.	<p>Providing and fixing tiled false ceiling of approved materials of size 595x595 mm in true horizontal level, suspended on inter locking metal grid of hot dipped galvanized steel sections (galvanized @ 120 grams/ sqm, both side inclusive) consisting of main "T" runner with suitably spaced joints to get required length and of size 24x38 mm made from 0.30 mm thick (minimum) sheet, spaced at 1200 mm center to center and cross "T" of size 24x25 mm made of 0.30 mm thick (minimum) sheet, 1200 mm long spaced between main "T" at 600 mm center to center to form a grid of 1200x600 mm and secondary cross "T" of length 600 mm and size 24x25 mm made of 0.30 mm thick (minimum) sheet to be interlocked at middle of the 1200x600 mm panel to form grids of 600x600 mm and wall angle of size 24x24x0.3mm and laying false ceiling tiles of approved texture in the grid including, required cutting/making, opening for services like diffusers, grills, light fittings, fixtures, smoke detectors etc. Main "T" runners to be suspended from ceiling using GI slotted cleats of size 27 x 37 x 25 x 1.6 mm fixed to ceiling with 12.5 mm dia and 50 mm long dash fasteners, 4mm GI adjustable rods with galvanized butterfly level clips of size 85 x 30 x 0.8 mm spaced at 1200 mm center to center along main T, bottom exposed width of 24 mm of all T-sections shall be pre-painted with polyester paint, all complete for all heights as per specifications, drawings and as directed by Engineer-in-charge. GI Metal Ceiling Lay in plain Tegular edge Global white color tiles of size 595x595 mm, and 0.5 mm thick with 8 mm drop; made of GI sheet having galvanizing of 100 gms/sqm (both sides inclusive) and electro statically polyester powder coated of thickness 60 microns (minimum), including factory painted after bending.</p>	Sqm	150
12	<p>Providing 20mm thick plaster of paris (gypsum anhydrous) ceiling up to height of 4m above floor level including coves &amp; moulding as per sample approved consisting of frame work made of special sections power pressed from MS sheet with galvanized coating consisting of ceiling angle hanger of 20x20x0.5mm thick of required length 1 and fixed to ceiling with dash fastener and other end with hanging arrangement G.I channels 45x25x0.9mm, 5 nos member running to which ceiling section 0.5mm thick bottom rail of 80mm with tapered flange of 26mm each fixed with self taping screws running in a direction perpendicular to G.I channel fixed with self taping screws @ 400c/c and perimeter angle 20x20x0.5mm fixed to wall with rawl plugs @ 900mm c/c. Providing &amp; fixing stainless steel grade 304 wire gauge with wire of dia 0.5mm mesh fixed to wedge shaped ceiling section i/c cutting &amp; making smooth surface with scaffolding etc. all complete as per directions of Officer in charge</p>	Sqm	350
13.	<p><b>Door &amp; Window :</b> Fixed / Shutter UPVC window shall be provided with all fitments. The window/ door frame and shutter will be manufactured using suitable UPVC sections. The window shutter shall be provided with glazing of Duag 20mm (5mm +10 mm Air gap+5 mm Thk ) thk toughened glass fixed using rubber gasket.</p>	Sqm	35

14	Providing and Fixing 35mm thick BWP flush doors cladded and pasted with 1mm designer laminate (Greenlam, Century or equivalent) on either sides with 38mmx4mm thick real wood margin on all sides fixed with new hinges, push button round locks in stainless steel finish and all other required hardwares viz door closer etc. ( Hettich, Doorset etc.); all complete ready to use.	Sqm	15
15	Providing & fixing double skinned fixed partitions wall with doors or openings wherever required fabricated out of 65mmx50mm Champ wood frame as horizontal & vertical sections @ 450mm c/c duly coated with wood primer to be fixed with wooden plugs, fixing 12mm thick water proof ply on both sides (duro / green or equivalent make) of the partition, finally fixing 1.0mm thick laminate on both sides of the partition with adhesive of approved brand providing 1mm thick groove at all joints or wherever required as per the drawings supplied and as per the instructions of the EIC. Double skin partition to be raised upto a height of 1300mm from the floor and the rest of the height upto ceiling height to be enclosed with 6mm thick glass factory made duly edge polished & finished with silicon filling and all required steel patch fittings if or wherever required to hold or join each panel, the surrounding area around all glass panes to be in 35mm x 15mm thick wooden sections cladded with 12mm ply and finally finished in matching 1.0mm thick laminate complete with all required teak beadings as required and directed.	Sqm	10
16	Providing & fixing 12mm thick factory made toughened glass of saint gobain or equivalent make for fixed glass partitions and/or doors in all sizes & shapes with all required cuts & holes for stainless steel patch & lock fittings, spacers, duly edge polished and finished to use and complete in all respects including filing the gaps with silicon sealant for fixing patch fittings. Steel patch fittings, locks, handles and floor machines etc.	Sqm	15
17.	Supplying and fixing door closer/fittings of sizes as given below as per direction of Officer in charge		
	a) Double cylinder floor spring (heavy duty - 90kg)	Nos	6
	b) Top patch fitting of Ozone / Dorma / Closma or equivalent make	Nos	6
	c) Bottom patch fitting with strike plate of ozone/dorma/closma or equivalent/ identical quality make	Nos	6
	d) Corner patch lock of ozone/ dorma / closma or equivalent make	Nos	6
	e) H - type or D- type handle (25 x 300mm) of safex / closma or equivalent make	Nos	6
18	Providing & fixing solar film frosted sparkle of lummar / 3M or equivalent make on toughened glass in approved design and pattern as per the drawing supplied or as per the instructions.	Sqm	35

19	Providing and fixing in position teak veneer ply paneling made out of frame work of 47 x 47mm M.S. tubes of 18 G thickness fixed to floor placed at 450/600mm (max.) c/c vertical and horizontal supported from existing wall/floor with appropriate and necessary dash fasteners to ensure stability. 50mm thick glass wool wrapped in tissue paper duly filled before ply paneling, the paneling consists of 12mm commercial ply with 4mm thick teak veneer, all teak wood section / teak veneer to be melamine polished and all frame of M.S. work to be properly welded including one coat of primer and one coat of synthetic enamel paint complete in all respects as per detailed drawings and as directed by the concerned official	Sqm	65
20	Providing and fixing in position teak veneer ply paneling with appropriate and necessary dash fasteners to ensure stability. The paneling consists of 12mm commercial ply with 4mm th. teak veneer, all teak wood section / teak veneer to be melamine polished and all frame with one coat of primer and one coat of synthetic enamel paint complete in all respects as per detailed drawings and as directed by the concerned official.	Sqm	250
21	Providing and fixing in position wooden paneling on side walls and windows at lift lobby area using 12mm BWR ply 4mm thick veneer (first quality) and melamine polishing.	Sqm	30
22	Providing & fixing 5mm thick looking mirror of superior quality (Modigaurd/AtulTuff/Saint Gobin make or equivalent quality) with 12mm thick commercial plywood in back of looking mirror and fixed to wooden cleats with C.P brass screws & washers complete with 50mm wide 2nd class teak wood ornamental beeding all around the mirror including polishing & fixing with teak wood plugs etc complete as per the directions.	Sqm	7
23	Painting & Polishing : Providing and applying three or more coats of best quality Plastic/ Velvet paint (Royal) of approved manufacture and shade to wall surfaces etc. applied evenly to give approved finish, including preparation of surface ( Wall putty- 2 coat or more) and coat of approved primer complete as per specifications to entire satisfaction of concerned officer for all levels and heights complete.	Sqm	1000
24	Providing & pasting imported graphic designer wall paper of 0.5mm thickness on existing walls including adhesive etc complete as per approved design by concerned officer.	Sqm	60
25	External Wall Paint : Providing & applying 2 coat of Exterior weather coat with sealant and cement primer coat on external surface . (Apex)	Sqm	100
26	Providing and Fixing Vitrified Floor tiles and skirting (100 mm height) in general & dry areas shall be of Vitrified Tiles 600x600mm of approved color laid on a bed of 20mm thick cement mortar 1:3 (1Cement:3 Coarse sand) finished with a flush pointing in tile grout with matching pigment including preparation of surface, cleaning etc complete. (Kajaria make or equivalent make)	Sqm	600
27	Providing and Fixing Flooring antiskid tiles of 07 mm thick Kajaria make or equivalent of approved colour & quality on over 1:3 cement motar bed of 20mm thick.	Sqm	50

28	Providing and Fixing Glazed Ceramic Tiles of 300x450mm or 300x300mm as available up to height of 2100mm in toilets shall be used for Dado/ wall tiles, of approved color and make, fixed on the wall with the help of adequate adhesive, finishing, cleaning etc complete. Joints to be finished with tile grout with matching pigment etc. Complete	Sqm	180
29	Water Supply and Sanitation: Providing and laying 20mm PPR pipes with UV layer & glass coating for external water supply & 16mm Polyethylene pack pipes for Internal water supply with elbows, bends & T's limited to the building structure only.	Mtr	50
30	Providing & fixing automatic hand dryer of make Euronics / Aircare / or equivalent good quality make with speed upto 60M/S and minimum 1200 watts power in stainless steel body, complete as per the directions of the Officer/ officer in charge.	Nos	04
31	Providing & fixing of manual type tissue paper dispenser of Kimberley clark / Aircare or equivalent quality make in ABS body complete as per the directions of the Officer/ officer in charge.	Nos	04
32	Providing & fixing manual push type soap dispenser of Kohler / Kimberley clark / Aircare / or equivalent quality make with capacity of 1000ml in ABS body complete as per the directions of the Officer or officer in charge.	Nos	05
33	Providing & fixing unplasticised pvc triple layer overhead water storage tank of approved brand and manufacture including the inlet and outlet provision etc.	Ltr	2000
34	Providing & fixing wall hung type toilet with soft close seat and cover of size 560x365x355mm of Kohler / Jaguar or equivalent make complete as per the direction of the Officer in charge	each	04
35	Providing & fixing white colour wash basin of Kohler / Jaguar or equivalent make complete over granite counter complete as per the direction of the Officer or officer in charge	each	04
36	Providing & fixing PVC concealed cistern with plate 8857 fitting & fixture of Kohler / jaguar or equivalent make complete with all fitting etc. as per the direction of the Officer in charge	each	04
37	Providing & fixing hand shower (health faucet) with metal hose & holder in polish chrome of Kohler / jaguar or equivalent make complete as per the direction of the Officer in charge	each	04
38	Providing & fixing white vitreous wall hung urinal with concealed fitting of Kohler / jaguar or equivalent make with back inlet and valve outlet including fixing to wall suitable brackets all as per manufacturer specifications and as per the direction of the officer in charge	each	04
39	Providing & fixing unplasticied PVC connection pipe with brass unions 60cm length and 15mm nominal bore as per the direction of the Officer in charge	each	20
40	Providing & fixing anti cockroach floor trap grating of sizes etc complete as per the directions of the officer in charge	each	06
41	Providing & fixing CP bottle trap of Kohler / Jaguar or equivalent make etc complete as per the directions.		



	(a) 32 mm nominal bore	each	04
42	Providing & fixing CP single lever Lavatory faucet or single hole single lever basin mixer with lever handle without drain of Kohler / Jaguar or equivalent make complete as per the directions.		
	(a) 15 mm nominal bore	each	04
43	Providing & fixing CP brass toilet paper holder with flap etc of Kohler / jaguar / aircare or equivalent make complete as per the directions of the Officer in charge	each	04
44	Providing & fixing CP brass angular stop cork (angle valve) with flange for basin mixer / geyser point of Kohler / jaguar or equivalent make complete as per the directions of the Officer in charge (a) 15 mm nominal bore, IS 8931	each	21
	<b>Furniture</b>		
45	Supply and placing in position centre table of the specification/size 1000mmX600mmX428mm with top panel thickness of 10mm thick toughened glass. The frame work/under structure of the table shall be of wooden frame. Glass top & bottom shelves shall be metal 1.2mm sheet cut froler design fixed with understructure complete as per manufacture's specifications and as per direction of officer	Nos	03
46	Supply and placing in position main officer desk/table of the specification of size 2100(w)mmX900(d)mmX750(h) mm.The table top shall be 25mm thick MFC (Melamine Faced Chipboard). The main table should be of duck noise profile edge in order to enhance the work space aesthetics. The material shall be as per manufacture's specifications and as per direction of officer.	Nos	05
47	Supply and placing in position joining table of the specification/size1200(w)mmX600(d)mmX750(h)mm with top panel thickness of 25mm using Melamine Faced Chipboard (MFC). The leg of joining table shall be of metal. The material shall be as per manufacture's specifications and as per direction of officer.	Nos	05
48	Providing and fixing file / storage cabinets in sizes as per design or site requirements made up of BWP block board (of different thicknesses as/ design) finished in machine pressed laminate (colour / texture to be as decided by EIC / matching to the adjoining work stations / wood work. A variation of up to 50mm in either dimension shall be tolerable for getting the desired product in mentioned makes. The inside to be finished in 1mm thick laminate or matching to the exteriors. A-class teak wood 4mm lipping / 2mm thick taping shall be used as lipping etc. wherever required, to be polished to match same shade as laminate. Cabinets to be made as per drawing provided , with all necessary fittings and fixtures such as telescopic channels, hinges, magnetic catchers (hettich make) and handles (S.S. brushed finish) , proper locking mechanism, pad lock with steel/ nickel finish, of godrej/doorset / harison or equivalent make etc. all complete. The cabinet shall be mounted either on floor or wall using 6 - 12mm waterproof ply (duro or equivalent ) as backing with wooden		

	anchors (gitti) placed @ 300mm c/c on wall. The item shall include making good any holes, wire managers, + fixing on wall wherever required.		
	a) Having depth of up to 350mm	Sqm	13
	b) Having Depth of up to 450mm	Sqm	12
	c) Having Depth of up to 600mm including modular stainless steel basket & fitting suitable for below counter kitchen / pantry cabinets for Pantry	Sqm	25
49	Providing & supplying magazine & newspaper racks for the office use, in size 36" height and 12" width made out of 19mm BWP ply fixed with 4mm thick veneer and 1mm thick laminate as per design, duly polished at all edges with teak wood margin having shelves and or pockets as per the size of magazines or publications, the stand should be free standing without being mounted on any walls with provision of stand or legs as per design.	Each	04
50	Supply of premium chair for computer tables with overall dimension (w) 49cm (D):63.0 cm (H): 81.5 cm and seat height (SH): 44-56 CM (adjustable). The seat/back shall be made up of 1.2 cm thick hot pressed plywood, upholstered with poly viscose fabric (67% polyester + 33% Viscose), ( color and texture as decided ) or polyester bearing the weight of 330 gm/mtr for a span of 1.2 meters. The seat and back shall be made up of molded Polyurethane Foamwith PVC lipping all round. The seat (SIZE: 49.0cm. (W) x 44.0cm. (D) Should have a water fall edge and back (SIZE: 50.0cm. (W) x 49.0cm. (H) Foam shall be designed with contoured lumbar support. The one-piece armrests shall be made of black integral skin polyurethane with 50-70 "A" Hardness and reinforced with M.S. insert. The armrests shall be scratch and weather resistant. The armrests shall be fitted to the seat with seat/armrest connecting strip assembly made of 0.5cm. thk. HR steel. The center pivot mechanism shall be designed with features: 3600 revolving type. 17° maximum tilt on pivot at center. Tilt tension adjustment. Upright locking. The bellows is 3 piece telescopic type and injection molded in black Polypropylene. The base shall be in chrome (glossy) finish and fitted with 5 nos. twin wheel castors (castor wheel dia. 5.0cm.). The pedestal shall be of 65.0 cm. pitch center dia. (75.0 cm with castors) The twin wheel castors should be injection molded in black Nylon for trouble free movement. To be placed on 3 <sup>rd</sup> and 4 <sup>th</sup> floors at newly created office space area.	Nos	10
51	Providing and fixing blinds of MAC make & approved shades with channels & operating system complete as per direction.		
	(a) Oaken Glow ( officer cabins )	Sqm	20
	(b) View Max screen	Sqm	70
52	Supplying and installation of modular computer work unit of minimum dimension 1200mm (W) x 600mm (D) x 760mm (H) with a 50mm thick panel oneither sides of total ht 2100mm.A variation of + -150mm either side shall be tolerable as/availability of product in mentioned makes. The work station shall be made up of 19mm BWP block board (in different thicknesses as per requirement of the design) finished in machine pressed 1.0mm	Nos	05

	<p>laminated color as decided by the client. The side and rear, 2100mm high partition panel of 50mm width, made up of multiple layers of 12mm / 19mm block board with outer finished paneling of laminate and tackable fabric as per the drawing provided. This partition member shall have in it a hollow space to run the Data and power cables, + space for recessed switch plate as per drawing provided, the said partition panels to have partly toughened glass verticals as design elements. The tack-able fabric shall be mounted on 12mm soft board including a set of trays with it. The color and texture of laminate, fabric etc. shall be a combination (as per the design or choice of the office in charge) as decided by buyer. The unit shall have a cabinets / drawers unit as per drawing provided. The drawers shall be supported on telescopic runners of hettich / ozone equivalent make. The lower portion shall have hinged shutter doors as per drawing, with spring loaded self closing hinges of hettich or equivalent make. All the drawers, cabinets shall have a tumbler locking mechanism classic furniture pad lock with steel/ nickel finish, of godrej / doorset / harison or equivalent make. All the handles shall be S.S brushed finish and to be as per approval by buyer/ client . The flat exposed edges shall be sealed with 4mm thick teak wood lipping duly duco painted in matching colour to the laminate around. The unit shall be complete in all respect including making space &amp; provisions for electrical agency for laying of wiring (telephone, power, data and voice) in provided raceways and provisions for fixing of switch plates, switches, sockets etc. The complete unit shall be having wire managers, required accessories etc.</p>		
53	<p>The Seat and Back Cushion of the chairs should be pressed on 12mm hot press moulded ply. The seat cushion of the chair should be made up of 50mm thick High Density of 45±2 Kg/m<sup>3</sup> polyurethane mould and back cushion should be made up of 38mm thick High Density 33±2 Kg/m<sup>3</sup>. The polyurethane foam shall be as per manufacturer's specification. The hardness of foam shall be 20 kg on hampden machine and 25% compression and it should be covered with fabric as per manufacturer's shade card. The arms of the chairs should be black .</p> <p>The Gas lift mechanism should be tested as per BIFMA X 05.01.2002 Standards. The pedestal should be five legged injection moulded in black 30% glass -filled nylon and fitted with 5 nos twin wheel castors. The castors of the chairs should be glass filled, twin wheel castors confirming to BIFMA Standards X 05.01.2002 tested to perform 1,00,000 cycles with 225 lbs Load. It should have synchro single point locking arrangement.</p> <p>Note - . The back and base of the chair should be supplied with fabric upholstered. (Fabric colour shall be approved by concern official )</p> <p>All material should be used of relevant ISI specification Overall Height of chair should be minimum 970 mm ( Inclusive of maximum adjustment of gas lift mechanism )</p> <p>All material should be of high quality used of relevant ISI specification and as approved by the concerned officer.</p>	Nos	160

54	<p>Providing and Supplying of ergonomically designed fabric upholstered high back revolving chair for Conference Room. The Seat and Back Cushion of the chairs should be pressed on 12mm hot press moulded ply. The seat cushion of the chair should be made up of 50mm thick High Density of 45±2 Kg/m<sup>3</sup> polyurethane mould and back cushion should be made up of 38mm thick High Density 33±2 Kg/m<sup>3</sup>. The polyurethane foam shall be as per manufacturer's specification. The hardness of foam shall be 20 kg on hampden machine and 25% compression and it should be covered with fabric as per manufacturer's shade card. (Fabric colour shall be approved by concern official)</p> <p>The arms of the chairs should be black as per manufacturer specification. The Gas lift mechanism should be tested as per BIFMA X 05.01.2002 Standards. The tilting mechanism should be synchro-tilt mechanism as per international ergonomics standards any position locking. The pedestal should be five legged injection moulded in black 30% glass –filled nylon and fitted with 5 nos twin wheel castors. The castors of the chairs should be glass filled, twin wheel castors confirming to BIFMA Standards X 05.01.2002 tested to perform 1,00,000 cycles with 225 lbs Load.</p> <p>NOTE: The back and base of chair should be supplied with black polypropylene moulded covers. (Fabric colour shall be approved by concern official) Overall Height of chair should be minimum 1225 mm (Inclusive of maximum adjustment of gas lift mechanism) All material should be used of relevant ISI specification and as approved by the concerned officer.</p>	Nos	05
55	<p><b><u>Specifications for fixed base cushion chair for conference room:</u></b></p> <p>The back chairs for the conference rooms and meeting rooms shall be low back chair. The arms of the chairs should be black . The chair shall be supplied with PU moulded seat and back .The under structure should be made of tubular cantilever type MS ERW tube black powder coated. The chair shall be supplied with fabric of approved make and shade for seat and back.</p> <p>Note -The back and base of the chair should be supplied with fabric upholstered. All material should be used of relevant ISI specification The dimensions of the chairs should be as follows:</p> <p>Overall Height of chair : 890 mm max.</p> <p>The chair should be preferably the same model/alike as that of conference room chair.</p>	Nos	15
56	<p>Providing and fixing <b><u>CONFERENCE ROOM Table</u></b> with the following specifications:-</p> <p>The table is to be supplied in completely knock down conditions for assembly at site.</p> <p>The construction of the main table shall be free standing structure constructed with the help of mini-fix dowels and pins.</p> <p>The table should be made up of min 32mm thick MDF board with balancing laminate.</p> <p>Top is finished with 0.6mm thick post forming laminate of Merino or equivalent make.</p>		

	<p>The table should have waterfall edge .The foil shall be coated with PU layer for better scratch and wear resistance. MDF Board shall be of Interior Grade as per IS 12406 : 2003 The table connections have to be made in such a way that no gaps should be seen in between the tables. The provision of Wire carrier shall be as per manufacturer specifications.</p>		
	Table shall be made in following configuration for Conference Hall:-		
	1) Conference Table 10 Seater ( 6000mm x 600mm – 1200mm x 600mm)	Nos	02
	2) Conference Table 1 Seater (1200 mm x 600 mm)	Nos	02
	Table For Training room		
	Table 05 Seater (3000mm x 500 mm)	Nos	08
	Table 03 Seater (1800mm x 500 mm)	Nos	08
	Table 02 Seater (1200mm x 500 mm)	Nos	02
	<b>Note :</b> The seating system/ table design shall be modular / changeable as per site of work/requirement/drawing.		
57	<b><u>Specifications for lounge sofa sets:</u></b>		
	Supplying one, two and three seated sofa sets of specified size and dimension. Seat rest,Back rest and Side arms assembly consists of a fabricated inner frame assembly with moulded polyurethane foam having density = 45 ± 2 Kg./cm which provides strength as well as comfort to the sofa. The complete moulded backrest assembly is covered with a replaceable fabric upholstery cover.		
	<b>Three seated sofa shall have overall size of 1800L x 740 D x 740 H mm Two seated sofa shall have overall size of 1300L x 740 D x 740 H mm One seated sofa shall have overall size of 600L x 740 D x 740 H mm</b>	Seat	20
	All material should be used of relevant ISI specification and as approved by the concerned officials.		
58	<b><u>Specifications for Centre Table for lounge :</u></b> The centre table should be of premium quality. It should be 10mm thick float glass with high Quality teak wood framing / MS ERU high quality chrome plated framing. Material should be used of relevant ISI specification and as approved by the concerned officer. Approx. Size shall be - 900mm(W)x 550mm(D)x 425 mm (H) (min) NOTE: The side table &centre table should be from the same model/alike.	Nos	03
59	<b><u>Specifications for side table :</u></b>	Nos	04

	The side table should be of premium quality. It should be 10mm thick float glass with high Quality teak wood framing / MS ERU high quality chrome plated framing. Material should be used of relevant ISI specification and as approved by the concerned officer.  Approx. Size shall be - 550mm (W)x 550mm(D)x 425 mm (H) (min) NOTE: The side table & centre table should be from the same model/alike.		
60	Providing & supplying modular folding food serving imported designer light weight trolley in wooden finish shelves, MS round pipe powder coated frame and wire baskets complete on wheels . As per the drawing.	Each	01

	<b><u>ELECTRICAL WORK AT ITC-FSAN</u></b>		
	<b>ELECTRICAL WORKS</b>		
61	Providing electrical work comprising of PVC Conduiting, Point wiring, Networking, Telephone-3 pair, raceways wherever shown (Havells FRLS), Modular Switches ( north west or equivalent), Sockets with boxes & respective cover plate (Havells or equivalent make)	720	Sqm
62	SITC of 36 watts LED down lighter of size 600x600mm direct in the false ceiling recessed type including testing & commissioning complete as required (Phillips/Leolux/wipro/Max or equivalent make) as per design	Each	20
63	SITC of 15 watt LED type Down Lighter fitting direct in the fall ceiling (Recessed) type i/c testing commissioning and connection etc complete as required (Phillips/Leolux /wipro/Max or equivalent make) up to 150mm in size whether round or square as per design	Each	190
64	SITC of ceiling fan, including wiring the down rods of standard length (upto 30 cm) fan sweep size 48" in plain white colour and plain standard design of standard brands like Crompton / Khaitan / Bajaj/ Usha or equivalent make as required.	Each	24
65	SITC of essential LED tube Fitting 4' 20w/840 T8 1nd 1200 on surface or cove i/c connection etc as required (Philips/Leolux/Wipro/Max or equivalent make) of 18 watt LED tube.	Each	40
66	Providing & supplying fridge (~300 ltrs)for storing minor soft drinks, juices or water bottles for placing inside wooden pantry cabinet	Each	1
67	Supply, Installation, Testing & commissioning (SITC) of up to 300mm plastic body fresh air fan in the existing opening i/c making the hole to suit the size of the above fan making good the damages connection, testing , commissioning etc. as reqd.	Each	6
68	Supply and fixing of compact type mirror light fitting suitable for energy efficient 12 watt LED lamp alongwith all accessories i/c S/F 1 No 7 watt LED lamp directly on wall connection etc as reqd.	Each	6



69	SITC of designer hanging lights above conference table in the main conference room / hall of maximum size up to 750mm x 200mm x 200mm fabricated out of fabric or glass on MS powder coated round or square bar frame fitted with CFL or LED bulbs as per design.	Each	12
70	SITC of Profile LED light fitting in 24mm x 26mm aluminium channels fitted with LED bulbs upto 100pc in each running meter length with SMPS of up to 120 watts max as required in wooden or POP false ceiling.	Mtr	60
71	<b>Cable Tray</b>		
	Providing and fixing of GI cable tray with properly support complete with GI threaded.		
	Cable Tray for copper piping (300 mm) without cover	RMT	20
	Cable Tray for copper piping (150 mm) without cover	RMT	20
<b><u>Details Of Audio Visual Equipment/Items</u></b>			
<b><u>DISPLAY ITEMS</u></b>			
72.	HD LED 75" Displays with wall mount	Samsung or equivalent make	DM75E 1
73.	HD LED 55" Displays with swivel wall mount	Panasonic or equivalent make	DC55E 4
<b><u>SWITCHING, INTERFACING SYSTEM, WIRLESS</u></b>			
74.	Wodden Podium with Logo	Custom or equivalent make	- 1
75.	Two-Input Wall plate Switcher for HDMI and VGA with Ethernet-Enabled HD Base T Output upto 70 M	Atlona or equivalent make	AT-HDVS-150-TX-WP 1
76.	HD BaseT Scaler with HDMI and Analog Audio Outputs	Atlona or equivalent make	AT-HDVS-150-RX 1
77.	2x8 HDMI to HDBaseT Distribution Amplifier with Extended Distance	Atlona or equivalent make	AT-UHD-CAT-8 1
78.	HDMI Over HDBaseT Receiver with Ethernet, RS-232, and IR	Atlona or equivalent make	AT-UHD-EX-70C-RX 5
79.	Wireless Collaboration Gateway with Required Accessories	Wepresent or equivalent make	Wepresent 1
80.	Three-input scaler for HDMI and VGA signals	Atlona or equivalent make	AT-HD-SC-500 1
<b><u>AUDIO</u></b>			
81.	Wilress Control Unit	Bayerdynamic or equivalent make	Quinta RS 1

82.	Delegate Microphones with Gooseneck Microphone 500mm/20"	Bayerdynamic or equivalent make	Quinta MU 21+Classis GM 115 Q	5
83.	Omnidirectional antenna for Quinta CU, triple-band 2,4/5,2 / 5,8 GHz, N(HF) female connector, for ceiling mounting with Antenna cable for Quinta, Cable with very low attenuation, N(HF) plugs, length 20 m (66 ft.)	Bayerdynamic or equivalent make	CA Q14+CA Q 32	1
84.	Single charger and power supply for Quinta	Bayerdynamic or equivalent make	CA 2459	5
85.	Two-way in-ceiling loudspeaker, 6.5" LF & 1" Tweeter, 80hm/60 Watts, 60Hz - 20KHz , White - PAIR	Apart or equivalent make	CM608	8
86.	Two Channel High Impedance Amplifiers – 100 Watts Per Channel	Crown or equivalent make	XLS 1002	1
87.	Wireless Handheld Microphone	AKG or equivalent make	Perception Wireless Handheld	2
88.	Wireless Lapel microphone	AKG or equivalent make	Perception Wireless Handheld	1
89.	Manual Mixer	Yamaha or equivalent make	MG06	1
<b><u>CABLE, CONNECTORS</u></b>				
90.	VGA, HDMI Cable, Speaker Cable, Mic Cable, UTP Cable	Custom or equivalent make	Custom or equivalent make	L.S.
91.	Equipment Rack	Indegionos or equivalent make	Indegionos or equivalent make	1
92.	Installation , Commissioning, Documentation, Training	Webcon or equivalent make	Webcon or equivalent make	1
<b><u>VRF AIRCONDITIONING SYSTEM</u></b>				
93.	<b><u>Installation of Variable Refrigerant Flow System</u></b>			
Supply, Installation , Testing and commissioning of Modular type outdoor units equipped with highly efficient scroll compressors. Each outdoor unit should have minimum 1 no. variable compressor up to 18 HP, 2 nos. variable compressors upto 32 HP capacity, 3nos. variable compressors up to 54 HP capacity with special heat exchanger, 20- 27 Steps speed control DC motor condenser fan , auto check function for connection error, auto address setting and in built				

	Double Stage Oil Separation to ensure minimum oil entrainment and proper lubrication. The condensing units should be capable for outside ambient 48 Deg. C.		
	24 HP Heat Pump Type- Top Discharge- 100 % INVERTER	Nos	02
94.	<b><u>INDOOR UNIT</u></b>		
	Supply , Installation , Testing and commissioning of Indoor units address setting and capacity as mentioned below. Multi-speed motor, coil section with DX coil, outer cabinet, drain pan mechanism insulation, pipe connections, etc of various capacities.		
	4 way cassette with wired/corded remote		
(a)	1.59TR/2.0 HP	Nos	03
(b)	2.0 TR/2.5 HP	Nos	08
(c)	2.65 TR/3.0 HP	Nos	03
(d)	3.2 TR/4.0 HP	Nos	03
95	<b>Hi Wall Units</b>		
	1.5 HP	Nos	02
96	<b>Y-Joints</b>	Nos	20
97.	Split 100% Cool only wall mounted Air -conditioners make Mitsubishi with maximum energy efficient i.e 5 or more star rating with complete fitting under buy back of old one split A.C. Complete installation with supportive low side work with no hidden cost		
(a)	1.8TR	Nos	01
(b)	1.5TR	Nos	01
(c)	1.0 TR	Nos	01
	<b><u>Airconditioning Systems other requirements for installations</u></b>		
98.	<b>Installation of Variable Refrigerant Flow System – Setfree</b>		
	Installation Modular type Set free outdoor units equipped with highly efficient scroll compressors .Each outdoor unit should have minimum 1no.variable compressor variable compressors upto 48HP capacity with special heat exchanger, 27 Steps speed control DC motor condenser fan ,auto check function for connection error, auto address setting and in built Double Stage Oil Separation to ensure minimum oil entrainment and proper lubrication. The condensing units should be capable for outside ambient 48 Deg. C.		
99.	<b>Installation, Testing and Commissioning Outdoor Unit</b>		
	24 HP	Nos	2
	<b><u>Indoor Units</u></b>		
	Installation, testing and commissioning of <b>SETFREE INDOOR</b> units , address setting and capacity as mentioned below. Multispeed motor, Coil Section with DX Coil, Outer Cabinet, drain pan mechanism insulation, pipe connections, fresh air intake connector and individually controlled louver setting for cassettes and concealed unit above 3 HP having higher air quantity of 400 CFM/tr etc. of various capacities as per OEM (Hitachi) specifications.		
100.	<b>Cassette Units</b>		
	1.59TR/2.0 HP	Nos	3
	2.0 TR/2.5 HP	Nos	8
	2.65TR/3.0 HP	Nos	3
	3.2 TR/ 4.0 HP	Nos	3
101.	<b>Hi-Wall Units</b>		
	Wall Mounted Split Type : 1.5 HP	Nos	2
	Corded Remote	Nos	20
	MS Stand for Outdoor Unit Mounting	Nos	2

102.	<b>Refrigerant Piping, Drain Piping and Cabling</b>		
	Supply installation testing and commissioning of Interconnecting refrigerant pipe work with (19mm/13 mm thick) closed cell elastomeric nitrile rubber tubular insulation between each set of indoor & outdoor units as per HITACHI STD & specifications, all piping inside the room shall be properly supported with MS hanger.		
	41.3 ( with 19 mm Insulation )	RMT	59
	34.9 ( with 19 mm Insulation )	RMT	65
	28.6 ( with 19 mm Insulation )	RMT	59
	22.2 ( with 19 mm Insulation )	RMT	65
	19.1 ( with 19 mm Insulation )	RMT	55
	15.9 ( with 19 mm Insulation )	RMT	95
	12.7 ( with 19 mm Insulation )	RMT	49
	9.5 ( with 19 mm Insulation )	RMT	95
	6.4 ( with 19 mm Insulation )	RMT	55
103.	<b>Cable Tray</b>		
	Providing and fixing of GI cable tray with properly support complete with GI threaded.		
	Cable Tray for copper piping (300 mm) without cover	RMT	20
	Cable Tray for copper piping (150 mm) without cover	RMT	20
104.	<b>Supply, installation, testing &amp; commissioning of Refnet Joints</b>	Nos.	20
105.	Providing and fixing rigid PVC piping complete with fittings, supports as per HITACHI Standards & specifications and duly insulated with 6 mm thick closed cell nitrile rubber insulation.		
	32 mm dia	RMT	76
	40mm dia	RMT	35
106.	Supply & fixing of control cum transmission wiring of Copper Conductor Cable alongwith Conduite for looping between indoor & outdoor VRF System & to main Central remote controller system		
	2 C X .75 Sq mm	RMT	350
107.	Cassette Frames – Welding	Nos.	20
108.	<b>Fire Alarm System</b>		
	Supplying and fixing of following sizes of steel conduit along with accessories in surface/recess including painting in case of surface conduit or cutting the wall and making good the same in case of recessed conduit as required		
	(a) 20 mm	Mtr	50
	(b) 25 mm	Mtr	100
109.	Supplying and drawing following sizesx of FRLS PVC insulated copper conductor, single core cable in the existing surface/recessed steel/PVC conduit as required		
	2 x 1.5 sq. mm	Mtr	500
110.	Supplying, installation, testing and commissioning of Analog Addressable Fire Alarm Control Panel (FACP) with battery charger and battery back up for 8 hours normal operation and one hour alarm operation. The FACP shall include a full featured operator interface control and annunciation panel that shall include a backlit 640-character liquid crystal display, and a QWERTY style alphanumeric keypad for the field programming and control of the fire alarm system. The panel should be equipped with sufficient numbers of loop with 20% spare capacity with each loop shall have a capacity of minimum 159 detectors and 159 modules in one loop. The panel shall be UL listed and FM approved and comply UL 864, 9th Edition requirement. The enclosure shall also be UL listed. The	Nos.	11

	quoted rate shall include supply of necessary software and hardware for programming the panel with all necessary licence.		
111.	Supply, installation, testing & commissioning of Analogue addressable Photo Electric type Smoke Detector with mounting base, address switch complete as required.	Nos.	75
112.	Analogue addressable rate of rise cum fixed temperature, thermistor type heat detector with mounting base, address switch complete as required.	Nos.	02
113.	Addressable Hooter (sound output of minimum 90 db ) cum strobe(strength of light 10 cd) with control module complete as required.	Nos.	02
114.	Supply, fixing, testing and commissioning of flush type response indicator with red coloured neon lamp.	Nos.	70
115.	Supplying, fixing, testing and commissioning of Addressable Manual Call Point complete with address switch. ( Not Break Glass units)	Nos.	02
116.	Supplying, fixing, testing and commissioning of Addressable control / relay modules for shutting down, AHUs, activation of Smoke exhaust fans, elevator recall etc.	Nos.	02
117.	Supplying, fixing, testing and commissioning of Addressable monitor module for connecting to Flow Switch /Tamper switches of sprinkler and water supply control valves etc.	Nos.	02
118.	Supply, installation, testing and commissioning of smart board of suitable size complete with all accessories including projector, desktop computer, speaker and all relevant accessories etc. as required	Nos.	01
119.	Supplying and fixing of following ways surface/recess mounting, vertical type, 415V, TPN MCB distribution board of sheet steel, dust protected, duly powder painted, inclusive of 200A, tinned copper bus bar, common neutral link, earth bar, din bar for mounting MCBs (but without MCBs and incomer) as required. (Note : Vertical type MCB TPDB is normally used where 3 phase outlets are required.)		
	8 way (4+24), Double door	Nos	02
	12 way (4+36), Double door	Nos	02
120.	Supplying and fixing following rating, four pole 415 V, isolator in the existing MCB DB complete with connections, testing and commissioning etc. as required.		
	63A	Nos	02
	100A	Nos	02
121.	Supplying and fixing 5A to 32A rating, 240/415V, 10Ka, "C" Curve, miniature circuit breaker suitable for inductive load of following poles in the existing MCB DB complete with connections, testing and commissioning etc. as required.		
	Single pole	Nos	60
122.	Earthing with G.I. earth plate 600 mm x 600 mm x 6 mm thick including accessories, and providing masonry enclosure with cover plate having locking arrangement and watering pipe of 2.7 meter long etc. (but without charcoal/coke and salt) as required	Set	04
123.	Extra for providing charcoal and salt of required quantity	Set	04
124.	Providing and fixing 25 mm x 5 mm G.I. strip in 40 mm G.I. pipe	Mtr	60
125.	Providing and laying of 6 mm G.I. wire on surface or on recess for loop earthing as required	Mtr	60
126.	Supplying of 01 No. PVC insulated and PVC sheathed/XLPE power cable of 1.1 kV grade of following size		

	(a) 3.5 x 70 sq. mm	Mtr	50
	(b) 2 x 10 sq. mm	Mtr	500
127.	Laying of one number PVC insulated and PVC sheathed/XLPE power cable of 1.1 kV grade of following size in the existing RCC/HUME/METAL pipe etc. as required		
	Upto 35 sq. mm	Mtr	100
	Above 35 sq. mm and upto 95 sq. mm	Mtr	10
128.	Laying and fixing of one number PVC insulated and PVC sheathed/XLPE power cable of 1.1 kV grade of following size on wall surface as required		
	Upto 25 sq. mm	Mtr	400
	Above 25 sq. mm and upto 120 sq. mm`	Mtr	90
129.	Supplying and making end termination with brass compression gland and aluminium lugs for following size of PVC insulated and PVC sheathed/ XLPE aluminium conductor cable of 1.1 kV grade as required		
	2 x 10 sq. mm	Nos	60
	2 x 70 sq. mm	Nos	02



Lay out plan of existing area where ITC-FSAN is proposed

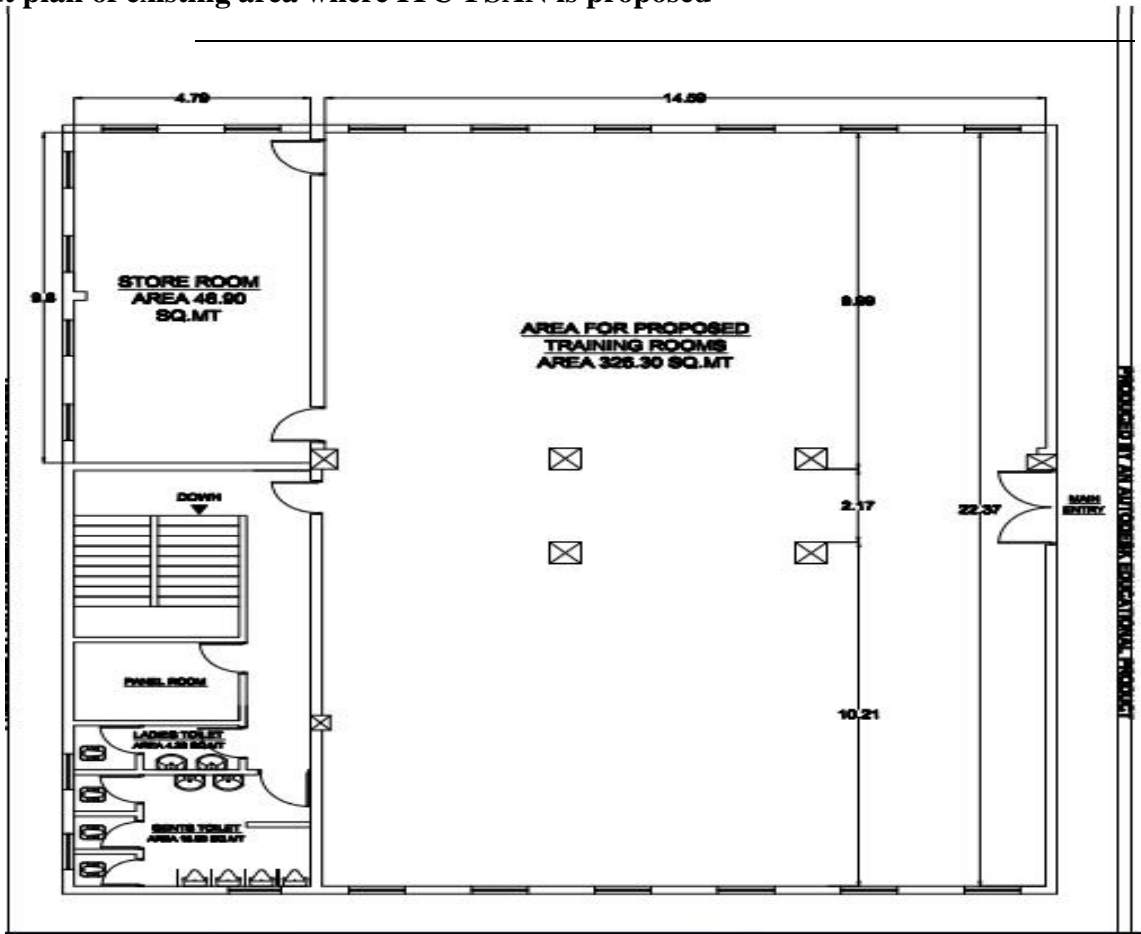

Lay out plan of the proposed classroom training at ITC-FSAN

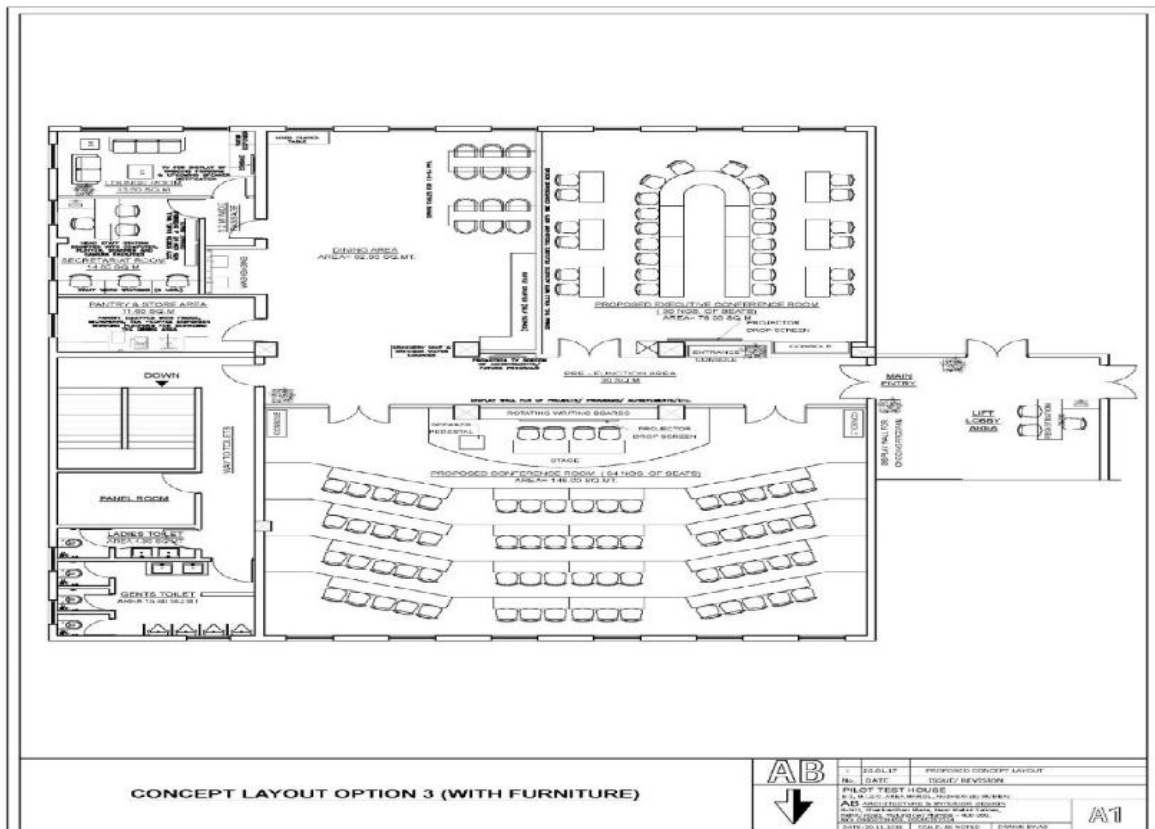

**Lay out plan proposed for HoTs Training Facility at ITCFSAN**

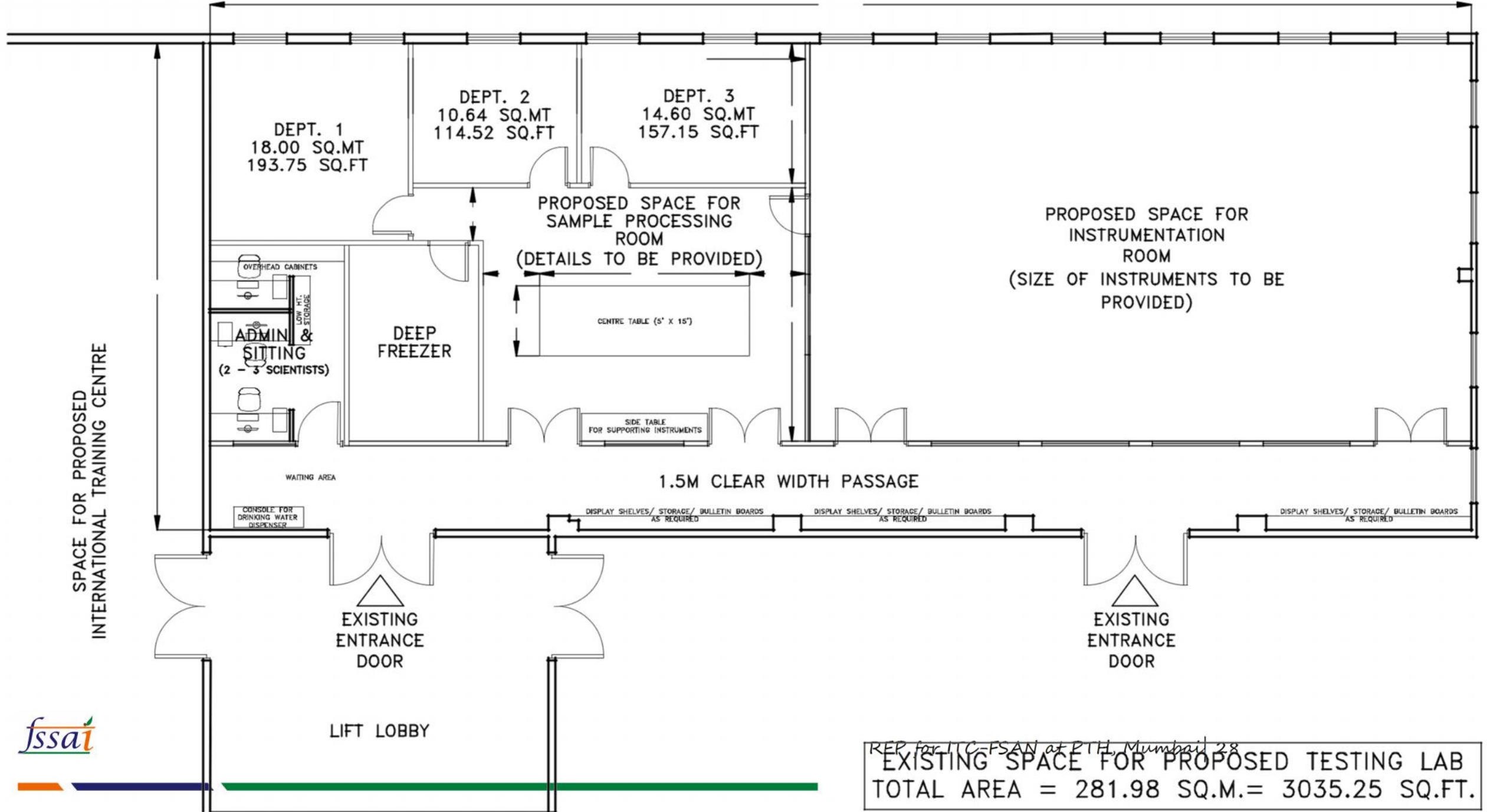

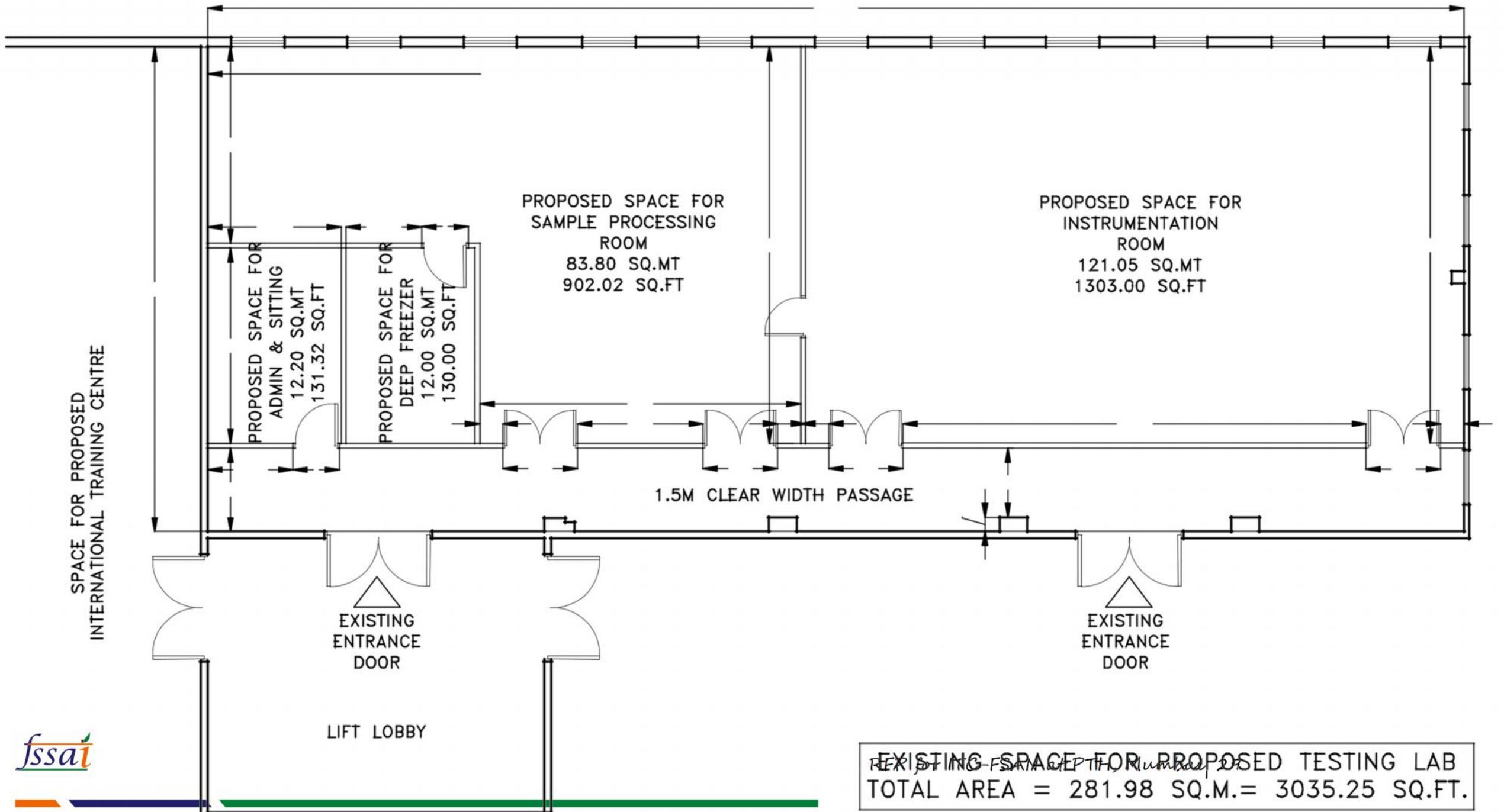

SPACE FOR PROPOSED  
INTERNATIONAL TRAINING CENTRE

PROPOSED SPACE FOR  
ADMIN & SITTING  
12.20 SQ.MT  
131.32 SQ.FT

PROPOSED SPACE FOR  
DEEP FREEZER  
12.00 SQ.MT  
130.00 SQ.FT

PROPOSED SPACE FOR  
SAMPLE PROCESSING  
ROOM  
83.80 SQ.MT  
902.02 SQ.FT

PROPOSED SPACE FOR  
INSTRUMENTATION  
ROOM  
121.05 SQ.MT  
1303.00 SQ.FT

1.5M CLEAR WIDTH PASSAGE

EXISTING  
ENTRANCE  
DOOR

LIFT LOBBY

EXISTING  
ENTRANCE  
DOOR

EXISTING SPACE FOR PROPOSED TESTING LAB  
TOTAL AREA = 281.98 SQ.M.= 3035.25 SQ.FT.



**CHECKLIST - FOR BIDDERS**

<b>S No.</b>	<b>Details</b>	<b>Yes / No</b>	<b>Remarks</b>
1.	DD/Banker's cheque/Fixed deposit receipt/Bank guarantee for <b>Rs.5,00,000/-</b> (Rupees Five Lakhs Only) in favour of <b>Senior Accounts Officer, FSSAI</b> payable at <b>New Delhi</b> towards EMD.		
2.	Detailed BOQ : Annexure -1		
3.	Classroom training and HoTs Layout : Annexure -2		
4.	Check List : Annexure – 3		
5.	Price-Bid : Annexure – 4		
6.	Performance Security – : Annexure – 5		
7.	Tender Form : Annexure 6		
8.	Bidder Profile : Annexure -7		
9.	Financial Status : Annexure-8		
10.	Letter of Authority : Annexure-9		
11.	Enclosed Xerox copy of PAN Card		
12.	Enclosed Xerox copy of GST Registration Certificate		
13.	Attached the copies of the financial statements, including all related notes and income statement for the last three Financial years i.e. 2015-16, 2016-17 and 2017 – 18.		
14.	Enclosed copy of work order / contract for at least of three works of Rs. 75 Lakh each or two works of Rs. 1.25 cr each or one composite work of building of Rs. 2.5 cr in Govt. Organisations.		
15.	Bank solvency Certificate issued not earlier than 31 March 2018.		

Note: Please note that in case if any of the documents mentioned above is/are not enclosed, bid may be rejected summarily.

**SIGNATURE OF BIDDER WITH SEAL AND DATE**

**Price-Bid**

**Inviting bids for for creation of ITC-FSAN with complete interiors, supply of furniture items, audio video equipment, air-conditioning system, their installation and other civil and Misc work at 2<sup>nd</sup> Pilot Test House, MIDC area, Andheri (East), Mumbai-400 069**

S.No.	Item/Description	Unit	Qty	Unit price	Total Price
<b>A</b>	<b>Civil Work</b>				
1	Demolishing of Brick Work manually/by mechanical means including stacking of serviceable material and disposal of unserviceable material from site as per direction of concerned official (a) Cement mortar	Cum	3		
2	Demolishing/ Chipping of Existing Stone / Tiles from floor manually/ by mechanical means including disposal of unserviceable material & usable material to be stake at site as per direction.	Sqm	600		
3	Removal of Malba by mechanical transport including loading, unloading and stacking at site for all lead and lift complete as per direction of concerned officer	Cum	14		
4	Providing and laying in position Cement Concrete 1:4:8 (1cement : 4coarse sand :8 graded stone aggregate 20mm nominal size of Coarse Sand) excluding the cost of centering and shuttering.	Cum	20		
5	Brick work with bricks of class designation 75 in Super structure in cement mortar 1:6 (1cement:6 coarse sand of zone-II)	Cum	5		
6	Half brick masonry with bricks of class designation 75 in super structure above plinth level in cement mortar 1:4(1cement :4 coarse sand of zone-II)	Sqm	15		
7	12 to 15mm cement plaster of mix ; 1:5( 1cement :5 fine sand of zone-IV ) including galvanized chicken wire mesh (24 gauge 12 mm size) to junctions of concrete and masonry work and other locations including cutting to required sizes, side laps of minimum 75 mm and fixing in position with galvanized iron wire nails, complete on ceiling or wherever required .	Sqm	40		

S.No.	Item/Description	Unit	Qty	Unit price	Total Price
8	Providing & fixing 18mm thick gang-saw cut, mirror polished, premoulded& pre-polished, machine cut for kitchen platform, vanity counter, window sills, facias, and similar location of required size, approved shade, colour& texture layed over 20mm thick base cement mortar 1:4 9 1 cement : 4 coarse sand), joints treated with white cement, mixed matching pigment, epoxy touch ups, including rubbing, curing, moulding& polishing to edges to give high gloss finish etc. complete at all levels.				
	(a) Granite of any colour of shade, area of slab over 0.50 sqm	Sqm	5		
9	Providing edge moulding to 18mm thick gang saw cut for kitchen platform, vanity counter, window sills, facias, and similar location of required size, including rubbing, moulding&polisging to edges to give high gloss finish etc complete at all levels				
	(a) Granite work	Mtr	5		
10	Providing & filling of low density material – cinder etc to raise the floor for race way etc.	Cum	35		
11.	Providing and fixing tiled false ceiling of approved materials of size 595x595 mm in true horizontal level, suspended on inter locking metal grid of hot dipped galvanized steel sections (galvanized @ 120 grams/ sqm, both side inclusive) consisting of main “T” runner with suitably spaced joints to get required length and of size 24x38 mm made from 0.30 mm thick (minimum) sheet, spaced at 1200 mm center to center and cross “T” of size 24x25 mm made of 0.30 mm thick (minimum) sheet,1200 mm long spaced between main “T” at 600 mm center to center to form a grid of 1200x600 mm and secondary cross “T” of length 600 mm and size 24x25 mm made of 0.30 mm thick (minimum) sheet to be interlocked at middle of the 1200x600 mm panel to form grids of 600x600 mm and wall angle of size 24x24x0.3mm and laying false ceiling tiles of approved texture in the grid including, required cutting/making, opening for services like diffusers, grills, light fittings, fixtures, smoke detectors etc. Main “T” runners to be suspended	Sqm	150		



S.No.	Item/Description	Unit	Qty	Unit price	Total Price
	from ceiling using GI slotted cleats of size 27 x 37 x 25 x 1.6 mm fixed to ceiling with 12.5 mm dia and 50 mm long dash fasteners, 4mm GI adjustable rods with galvanized butterfly level clips of size 85 x 30 x 0.8 mm spaced at 1200 mm center to center along main T, bottom exposed width of 24 mm of all T-sections shall be pre-painted with polyester paint, all complete for all heights as per specifications, drawings and as directed by Engineer-in-charge. GI Metal Ceiling Lay in plain Tegular edge Global white color tiles of size 595x595 mm, and 0.5 mm thick with 8 mm drop; made of GI sheet having galvanizing of 100 gms/sqm (both sides inclusive) and electro statically polyester powder coated of thickness 60 microns (minimum), including factory painted after bending.				
12	Providing 20mm thick plaster of paris (gypsum anhydrous) ceiling up to height of 4m above floor level including coves & moulding as per sample approved consisting of frame work made of special sections power pressed from MS sheet with galvanized coating consisting of ceiling angle hanger of 20x20x0.5mm thick of required length 1 and fixed to ceiling with dash fastener and other end with hanging arrangement G.I channels 45x25x0.9mm, 5 nos member running to which ceiling section 0.5mm thick bottom rail of 80mm with tapered flange of 26mm each fixed with self taping screws running in a direction perpendicular to G.I channel fixed with self taping screws @ 400c/c and perimeter angle 20x20x0.5mm fixed to wall with rawl plugs @ 900mm c/c. Providing & fixing stainless steel grade 304 wire gauge with wire of dia 0.5mm mesh fixed to wedge shaped ceiling section i/c cutting & making smooth surface with scaffolding etc. all complete as per directions of Officer in charge	Sqm	350		
13.	<b>Door &amp; Window :</b> Fixed / Shutter UPVC window shall be provided with all fitments. The window/ door frame and shutter will be manufactured using suitable UPVC sections. The window shutter shall be provided with glazing of Duag 20mm (5mm +10 mm Air gap+5	Sqm	35		

S.No.	Item/Description	Unit	Qty	Unit price	Total Price
	mm Thk ) thk toughened glass fixed using rubber gasket.				
14	Providing and Fixing 35mm thick BWP flush doors clad and pasted with 1mm designer laminate (Greenlam, Century or equivalent) on either sides with 38mmx4mm thick real wood margin on all sides fixed with new hinges, push button round locks in stainless steel finish and all other required hardwares viz door closer etc. ( Hettich, Doorset etc.); all complete ready to use.	Sqm	15		
15.	Providing & fixing double skinned fixed partitions wall with doors or openings wherever required fabricated out of 65mmx50mm Champ wood frame as horizontal & vertical sections @ 450mm c/c duly coated with wood primer to be fixed with wooden plugs, fixing 12mm thick water proof ply on both sides (duro / green or equivalent make) of the partition, finally fixing 1.0mm thick laminate on both sides of the partition with adhesive of approved brand providing 1mm thick groove at all joints or wherever required as per the drawings supplied and as per the instructions of the EIC. Double skin partition to be raised upto a height of 1300mm from the floor and the rest of the height upto ceiling height to be enclosed with 6mm thick glass factory made duly edge polished & finished with silicon filling and all required steel patch fittings if or wherever required to hold or join each panel, the surrounding area around all glass panes to be in 35mm x 15mm thick wooden sections clad with 12mm ply and finally finished in matching 1.0mm thick laminate complete with all required teak beadings as required and directed.	Sqm	10		
16	Providing & fixing 12mm thick factory made toughened glass of saint gobain or equivalent make for fixed glass partitions and/or doors in all sizes & shapes with all required cuts & holes for stainless steel patch & lock fittings, spacers, duly edge polished and finished to use and complete in all respects	Sqm	15		

S.No.	Item/Description	Unit	Qty	Unit price	Total Price
	including filing the gaps with silicon sealant for fixing patch fittings. Steel patch fittings, locks, handles and floor machines etc.				
17.	Supplying and fixing door closer/fittings of sizes as given below as per direction of Officer in charge				
	a) Double cylinder floor spring (heavy duty - 90kg)	Nos	6		
	b) Top patch fitting of Ozone / Dorma / Closma or equivalent make	Nos	6		
	c) Bottom patch fitting with strike plate of ozone/dorma/closma or equivalent/ identical quality make	Nos	6		
	d) Corner patch lock of ozone/ dorma / closma or equivalent make	Nos	6		
	e) H - type or D- type handle (25 x 300mm) of safex / closma or equivalent make	Nos	6		
18	Providing & fixing solar film frosted sparkle of lummar / 3M or equivalent make on toughened glass in approved design and pattern as per the drawing supplied or as per the instructions.	Sqm	35		
19	Providing and fixing in position teak veneer ply paneling made out of frame work of 47 x 47mm M.S. tubes of 18 G thickness fixed to floor placed at 450/600mm (max.) c/c vertical and horizontal supported from existing wall/floor with appropriate and necessary dash fasteners to ensure stability. 50mm thick glass wool wrapped in tissue paper duly filled before ply paneling, the paneling consists of 12mm commercial ply with 4mm thick teak veneer, all teak wood section / teak veneer to be melamine polished and all frame of M.S. work to be properly welded including one coat of primer and one coat of synthetic enamel paint complete in all respects as per detailed drawings and as directed by the concerned official	Sqm	65		

S.No.	Item/Description	Unit	Qty	Unit price	Total Price
20	Providing and fixing in position teak veneer ply paneling with appropriate and necessary dash fasteners to ensure stability. The paneling consists of 12mm commercial ply with 4mm th. teak veneer, all teak wood section / teak veneer to be melamine polished and all frame with one coat of primer and one coat of synthetic enamel paint complete in all respects as per detailed drawings and as directed by the concerned official.	Sqm	250		
21	Providing and fixing in position wooden paneling on side walls and windows at lift lobby area using 12mm BWR ply 4mm thick veneer (first quality) and melamine polishing.	Sqm	30		
22	Providing & fixing 5mm thick looking mirror of superior quality (Modigaurd/AtulTuff/Saint Gobin make or equivalent quality) with 12mm thick commercial plywood in back of looking mirror and fixed to wooden cleats with C.P brass screws & washers complete with 50mm wide 2nd class teak wood ornamental beeding all around the mirror including polishing & fixing with teak wood plugs etc complete as per the directions.	Sqm	7		
23	Painting & Polishing : Providing and applying three or more coats of best quality Plastic/ Velvet paint (Royal) of approved manufacture and shade to wall surfaces etc. applied evenly to give approved finish, including preparation of surface ( Wall putty- 2 coat or more) and coat of approved primer complete as per specifications to entire satisfaction of concerned officer for all levels and heights complete.	Sqm	1000		
24	Providing & pasting imported graphic designer wall paper of 0.5mm thickness on existing walls including adhesive etc complete as per approved design by concerned officer.	Sqm	60		
25	External Wall Paint : Providing & applying 2 coat of Exterior weather coat with sealant and cement primer coat on external surface . (Apex)	Sqm	100		

S.No.	Item/Description	Unit	Qty	Unit price	Total Price
26	Providing and Fixing Vitrified Floor tiles and skirting (100 mm height) in general & dry areas shall be of Vitrified Tiles 600x600mm of approved color laid on a bed of 20mm thick cement mortar 1:3 (1Cement:3 Coarse sand) finished with a flush pointing in tile grout with matching pigment including preparation of surface, cleaning etc complete. (Kajaria make or equivalent make)	Sqm	600		
27	Providing and Fixing Flooring antiskid tiles of 07 mm thick Kajaria make or equivalent of approved colour & quality on over 1:3 cement motar bed of 20mm thick.	Sqm	50		
28	Providing and Fixing Glazed Ceramic Tiles of 300x450mm or 300x300mm as available up to height of 2100mm in toilets shall be used for Dado/ wall tiles, of approved color and make, fixed on the wall with the help of adequate adhesive, finishing, cleaning etc complete. Joints to be finished with tile grout with matching pigment etc. Complete	Sqm	180		
29	Water Supply and Sanitation: Providing and laying 20mm PPR pipes with UV layer & glass coating for external water supply & 16mm Polyethylene pack pipes for Internal water supply with elbows, bends & T's limited to the building structure only.	Mtr	50		
30	Providing & fixing automatic hand dryer of make Euronics / Aircare / or equivalent good quality make with speed upto 60M/S and minimum 1200 watts power in stainless steel body, complete as per the directions of the Officer/ officer in charge.	Nos	04		
31	Providing & fixing of manual type tissue paper dispenser of Kimberley clark / Aircare or equivalent quality make in ABS body complete as per the directions of the Officer/ officer incharge.	Nos	04		
32	Providing & fixing manual push type soap dispenser of Kohler / Kimberley clark / Aircare / or equivalent quality make with capacity of 1000ml in ABS body complete as per the directions of the Officer or officer in charge.	Nos	05		

S.No.	Item/Description	Unit	Qty	Unit price	Total Price
33	Providing & fixing unplasticised pvc triple layer overhead water storage tank of approved brand and manufacture including the inlet and outlet provision etc.	Ltr	2000		
34	Providing & fixing wall hung type toilet with soft close seat and cover of size 560x365x355mm of Kohler / Jaguar or equivalent make complete as per the direction of the Officer in charge	each	04		
35	Providing & fixing white colour wash basin of Kohler / Jaguar or equivalent make complete over granite counter complete as per the direction of the Officer or officer in charge	each	04		
36	Providing & fixing PVC concealed cistern with plate 8857 fitting & fixture of Kohler / jaguar or equivalent make complete with all fitting etc. as per the direction of the Officer in charge	each	04		
37	Providing & fixing hand shower (health faucet) with metal hose & holder in polish chrome of Kohler / jaguar or equivalent make complete as per the direction of the Officer in charge	each	04		
38	Providing & fixing white vitreous wall hung urinal with concealed fitting of Kohler / jaguar or equivalent make with back inlet and valve outlet including fixing to wall suitable brackets all as per manufacturer specifications and as per the direction of the officer in charge	each	04		
39	Providing & fixing unplasticied PVC connection pipe with brass unions 60cm length and 15mm nominal bore as per the direction of the Officer in charge	each	20		
40	Providing & fixing anti cockroach floor trap grating of sizes etc complete as per the directions of the officer in charge	each	06		
41	Providing & fixing CP bottle trap of Kohler / Jaguar or equivalent make etc complete as per the directions.				
	(b) 32 mm nominal bore	each	04		



S.No.	Item/Description	Unit	Qty	Unit price	Total Price
42	Providing & fixing CP single lever Lavatory faucet or single hole single lever basin mixer with lever handle without drain of Kohler / Jaguar or equivalent make complete as per the directions.				
	(b) 15 mm nominal bore	each	04		
43	Providing & fixing CP brass toilet paper holder with flap etc of Kohler / jaguar / aircare or equivalent make complete as per the directions of the Officer in charge	each	04		
44	Providing & fixing CP brass angular stop cork (angle valve) with flange for basin mixer / geyser point of Kohler / jaguar or equivalent make complete as per the directions of the Officer in charge				
	(a) 15 mm nominal bore, IS 8931	each	21		
	<b>Furniture</b>				
45	Supply and placing in position centre table of the specification/size 1000mmX600mmX428mm with top panel thickness of 10mm thick toughened glass. The frame work/under structure of the table shall be of wooden frame. Glass top & bottom shelves shall be metal 1.2mm sheet cut froler design fixed with understructure complete as per manufacture's specifications and as per direction of officer	Nos	03		
46	Supply and placing in position main officer desk/table of the specification of size 2100(w)mmX900(d)mmX750(h) mm.The table top shall be 25mm thick MFC (Melamine Faced Chipboard). The main table should be of duck noise profile edge in order to enhance the work space aesthetics. The material shall be as per manufacture's specifications and as per direction of officer.	Nos	05		

S.No.	Item/Description	Unit	Qty	Unit price	Total Price
47	Supply and placing in position joining table of the specification/size 1200(w)mmX600(d)mmX750(h)mm with top panel thickness of 25mm using Melamine Faced Chipboard (MFC). The leg of joining table shall be of metal. The material shall be as per manufacture's specifications and as per direction of officer.	Nos	05		
48	Providing and fixing file / storage cabinets in sizes as per design or site requirements made up of BWP block board (of different thicknesses as/ design) finished in machine pressed laminate (colour / texture to be as decided by EIC / matching to the adjoining work stations / wood work. A variation of up to 50mm in either dimension shall be tolerable for getting the desired product in mentioned makes. The inside to be finished in 1mm thick laminate or matching to the exteriors. A-class teak wood 4mm lipping / 2mm thick taping shall be used as lipping etc. wherever required, to be polished to match same shade as laminate. Cabinets to be made as per drawing provided , with all necessary fittings and fixtures such as telescopic channels, hinges, magnetic catchers (hettich make) and handles (S.S. brushed finish) , proper locking mechanism, pad lock with steel/ nickel finish, of godrej/doorset / harison or equivalent make etc. all complete. The cabinet shall be mounted either on floor or wall using 6 - 12mm waterproof ply (duro or equivalent ) as backing with wooden anchors (gitti) placed @ 300mm c/c on wall. The item shall include making good any holes, wire managers, + fixing on wall wherever required.				
	a) Having depth of up to 350mm	Sqm	13		
	b) Having Depth of up to 450mm	Sqm	12		
	c) Having Depth of up to 600mm including modular stainless steel basket & fitting suitable for below counter kitchen / pantry cabinets for Pantry	Sqm	25		

S.No.	Item/Description	Unit	Qty	Unit price	Total Price
49	Providing & supplying magazine & newspaper racks for the office use, in size 36" height and 12" width made out of 19mm BWP ply fixed with 4mm thick veneer and 1mm thick laminate as per design, duly polished at all edges with teak wood margin having shelves and or pockets as per the size of magazines or publications, the stand should be free standing without being mounted on any walls with provision of stand or legs as per design.	Each	04		
50	Supply of premium chair for computer tables with overall dimension (w) 49cm (D):63.0 cm (H): 81.5 cm and seat height (SH): 44-56 CM (adjustable). The seat/back shall be made up of 1.2 cm thick hot pressed plywood, upholstered with poly viscose fabric (67% polyester + 33% Viscose), ( color and texture as decided ) or polyester bearing the weight of 330 gm/mtr for a span of 1.2 meters. The seat and back shall be made up of molded Polyurethane Foam with PVC lipping all round. The seat (SIZE: 49.0cm. (W) x 44.0cm. (D) Should have a water fall edge and back (SIZE: 50.0cm. (W) x 49.0cm. (H) Foam shall be designed with contoured lumbar support. The one-piece armrests shall be made of black integral skin polyurethane with 50-70 "A" Hardness and reinforced with M.S. insert. The armrests shall be scratch and weather resistant. The armrests shall be fitted to the seat with seat/armrest connecting strip assembly made of 0.5cm. thk. HR steel. The center pivot mechanism shall be designed with features: 3600 revolving type. 17° maximum tilt on pivot at center. Tilt tension adjustment. Upright locking. The bellows is 3 piece telescopic type and injection molded in black Polypropylene. The base shall be in chrome (glossy) finish and fitted with 5 nos. twin wheel castors (castor wheel dia. 5.0cm.). The pedestal shall be of 65.0 cm. pitch center dia. (75.0 cm with castors) The twin wheel castors should be injection molded in black Nylon for trouble free movement. To be placed on 3rd and 4th floors at newly created office space area.	Nos	10		

S.No.	Item/Description	Unit	Qty	Unit price	Total Price
51	Providing and fixing blinds of MAC make & approved shades with channels & operating system complete as per direction.				
	(a) Oaken Glow ( officer cabins )	Sqm	20		
	(b) View Max screen	Sqm	70		
52	Supplying and installation of modular computer work unit of minimum dimension 1200mm (W) x 600mm (D) x 760mm (H) with a 50mm thick panel oneither sides of total ht 2100mm.A variation of + -150mm either side shall be tolerable as/availability of product in mentioned makes. The work station shall be made up of 19mm BWP block board (in different thicknesses as per requirement of the design) finished in machine pressed 1.0mm laminate color as decided by the client. The side and rear, 2100mm high partition panel of 50mm width, made up of multiple layers of 12mm / 19mm block board with outer finished paneling of laminate and tackable fabric as per the drawing provided. This partition member shall have in it a hollow space to run the Data and power cables, + space for recessed switch plate as per drawing provided, the said partition panels to have partly toughened glass verticals as design elements. The tack-able fabric shall be mounted on 12mm soft board including a set of trays with it. The color and texture of laminate, fabric etc. shall be a combination (asper the design or choice of the office in charge) as decided by buyer. The unit shall have a cabinets / drawers unit as per drawing provided. The drawers shall be supported on telescopic runners of hettich / ozone equivalent make. The lower portion shall have hinged shutter doors as per drawing, with spring loaded self closing hinges of hettich or equivalent make. All the drawers, cabinets shall have a tumbler locking mechanism classic furniture pad lock with steel/ nickel finish, of godrej / doorset / harison or equivalent make. All the handles shall be S.S brushed finish and to be as per approval by buyer/ client . The flat exposed edges shall be sealed with 4mm	Nos	05		

S.No.	Item/Description	Unit	Qty	Unit price	Total Price
	thick teak wood lipping duly duco painted in matching colour to the laminate around. The unit shall be complete in all respect including making space & provisions for electrical agency for laying of wiring (telephone, power, data and voice) in provided raceways and provisions for fixing of switch plates, switches, sockets etc. The complete unit shall be having wire managers, required accessories etc.				
53	<p>The Seat and Back Cushion of the chairs should be pressed on 12mm hot press moulded ply. The seat cushion of the chair should be made up of 50mm thick High Density of 45±2 Kg/m<sup>3</sup> polyurethane mould and back cushion should be made up of 38mm thick High Density 33±2 Kg/m<sup>3</sup>. The polyurethane foam shall be as per manufacturer's specification. The hardness of foam shall be 20 kg on hampden machine and 25% compression and it should be covered with fabric as per manufacturer's shade card. The arms of the chairs should be black.</p> <p>The Gas lift mechanism should be tested as per BIFMA X 05.01.2002 Standards. The pedestal should be five legged injection moulded in black 30% glass – filled nylon and fitted with 5 nos twin wheel castors. The castors of the chairs should be glass filled, twin wheel castors confirming to BIFMA Standards X 05.01.2002 tested to perform 1,00,000 cycles with 225 lbs Load. It should have synchro single point locking arrangement.</p> <p>Note -. The back and base of the chair should be supplied with fabric upholstered. (Fabric colour shall be approved by concern official )</p> <p>All material should be used of relevant ISI specification Overall Height of chair should be minimum 970 mm ( Inclusive of maximum adjustment of gas lift mechanism )</p> <p>All material should be of high quality used of relevant ISI specification and as approved by the concerned officer.</p>	Nos	160		
54	Providing and Supplying of ergonomically designed fabric upholstered high back revolving chair for Conference Room. The Seat and Back	Nos	05		

S.No.	Item/Description	Unit	Qty	Unit price	Total Price
	Cushion of the chairs should be pressed on 12mm hot press moulded ply. The seat cushion of the chair should be made up of 50mm thick High Density of 45±2 Kg/m <sup>3</sup> polyurethane mould and back cushion should be made up of 38mm thick High Density 33±2 Kg/m <sup>3</sup> . The polyurethane foam shall be as per manufacturer's specification. The hardness of foam shall be 20 kg on hampden machine and 25% compression and it should be covered with fabric as per manufacturer's shade card. (Fabric colour shall be approved by concern official)				
	The arms of the chairs should be black as per manufacturer specification. The Gas lift mechanism should be tested as per BIFMA X 05.01.2002 Standards. The tilting mechanism should be synchro-tilt mechanism as per international ergonomics standards any position locking. The pedestal should be five legged injection moulded in black 30% glass –filled nylon and fitted with 5 nos twin wheel castors. The castors of the chairs should be glass filled, twin wheel castors confirming to BIFMA Standards X 05.01.2002 tested to perform 1,00,000 cycles with 225 lbs Load.				
	NOTE: The back and base of chair should be supplied with black polypropylene moulded covers. (Fabric colour shall be approved by concern official) Overall Height of chair should be minimum 1225 mm (Inclusive of maximum adjustment of gas lift mechanism) All material should be used of relevant ISI specification and as approved by the concerned officer.				
55	Specifications for fixed base cushion chair for conference room : The back chairs for the conference rooms and meeting rooms shall be low back chair. The arms of the chairs should be black . The chair shall be supplied with PU moulded seat and back .The under structure should be made of tubular cantilever type MS ERW tube black powder coated. The chair shall be supplied with fabric of approved make and shade for seat and back. Note -The back and base of the chair should be supplied with fabric upholstered. All material should be used	Nos	15		



S.No.	Item/Description	Unit	Qty	Unit price	Total Price
	of relevant ISI specification The dimensions of the chairs should be as follows: Overall Height of chair : 890 mm max. The chair should be preferably the same model/alike as that of conference room chair.				
56	Providing and fixing <b>CONFERENCE ROOM</b> Table with the following specifications:- The table is to be supplied in completely knock down conditions for assembly at site. The construction of the main table shall be free standing structure constructed with the help of mini-fix dowels and pins. The table should be made up of min 32mm thick MDF board with balancing laminate. Top is finished with 0.6mm thick post forming laminate of Merino or equivalent make. The table should have waterfall edge .The foil shall be coated with PU layer for better scratch and wear resistance. MDF Board shall be of Interior Grade as per IS 12406 : 2003 The table connections have to be made in such a way that no gaps should be seen in between the tables. The provision of Wire carrier shall be as per manufacturer specifications.				
	Table shall be made in following configuration for Conference Hall:-				
	1) Conference Table 10 Seater ( 6000mm x 600mm - 1200mm x 600mm)	Nos	02		
	2) Conference Table 1 Seater (1200 mm x 600 mm)	Nos	02		
	Table For Training room				
	Table 05 Seater (3000mm x 500 mm)	Nos	08		
	Table 03 Seater (1800mm x 500 mm)	Nos	08		
	Table 02 Seater (1200mm x 500 mm)	Nos	02		
	Note : The seating system/ table design shall be modular / changeable as per site of work/requirement/drawing.				
57	Specifications for lounge sofa sets:				

S.No.	Item/Description	Unit	Qty	Unit price	Total Price
	Supplying one, two and three seated sofa sets of specified size and dimension. Seat rest, Back rest and Side arms assembly consists of a fabricated inner frame assembly with moulded polyurethane foam having density = 45 ± 2 Kg./cm which provides strength as well as comfort to the sofa. The complete moulded backrest assembly is covered with a replaceable fabric upholstery cover.				
	Three seated sofa shall have overall size of 1800L x 740 D x 740 H mm Two seated sofa shall have overall size of 1300L x 740 D x 740 H mm One seated sofa shall have overall size of 600L x 740 D x 740 H mm  <b>All material should be used of relevant ISI specification and as approved by the concerned officials.</b>	Seat	20		
58	<b>Specifications for Centre Table for lounge :</b>				
	The centre table should be of premium quality. It should be 10mm thick float glass with high Quality teak wood framing / MS ERU high quality chrome plated framing.	Nos	03		
	Material should be used of relevant ISI specification and as approved by the concerned officer.				
	Approx. Size shall be - 900mm(W)x 550mm(D)x 425 mm (H) (min)				
	NOTE: The side table & centre table should be from the same model/alike.				
59	<b>Specifications for side table :</b>	Nos	04		
	The side table should be of premium quality. It should be 10mm thick float glass with high Quality teak wood framing / MS ERU high quality chrome plated framing. Material should be used of relevant ISI specification and as approved by the concerned officer.				
	Approx. Size shall be - 550mm (W)x 550mm(D)x 425 mm (H) (min)				
	NOTE: The side table & centre table should be from the same model/alike.				
60	Providing & supplying modular folding food serving imported designer light weight trolley in wooden finish shelves, MS round pipe powder coated frame and wire baskets complete on wheels . As per the drawing.	Each	01		

S.No.	Item/Description	Unit	Qty	Unit price	Total Price
	<b>ELECTRICAL WORKS</b>				
61	Providing electrical work comprising of PVC Conduiting, Point wiring, Networking, Telephone-3 pair, raceways wherever shown (Havells FRLS), Modular Switches ( north west or equivalent), Sockets with boxes & respective cover plate (Havells or equivalent make)	720	Sqm		
62	SITC of 36 watts LED down lighter of size 600x600mm direct in the false ceiling recessed type including testing & commissioning complete as required (Phillips/Leolux/wipro/Max or equivalent make) as per design	Each	20		
63	SITC of 15 watt LED type Down Lighter fitting direct in the fall ceiling (Recessed) type i/c testing commissioning and connection etc complete as required (Phillips/Leolux /wipro/Max or equivalent make) up to 150mm in size whether round or square as per design	Each	190		
64	SITC of ceiling fan, including wiring the down rods of standard length (upto 30 cm) fan sweep size 48" in plain white colour and plain standard design of standard brands like Crompton / Khaitan / Bajaj/ Usha or equivalent make as required.	Each	24		
65	SITC of essential LED tube Fitting 4' 20w/840 T8 1nd 1200 on surface or cove i/c connection etc as required (Philips/Leolux/Wipro/Max or equivalent make) of 18 watt LED tube.	Each	40		
66	Providing & supplying fridge (~300 ltrs)for storing minor soft drinks, juices or water bottles for placing inside wooden pantry cabinet	Each	1		
67	Supply, Installation, Testing & commissioning (SITC) of up to 300mm plastic body fresh air fan in the existing opening i/c making the hole to suit the size of the above fan making good the damages connection, testing , commissioning etc. as reqd.	Each	6		
68	Supply and fixing of compact type mirror light fitting suitable for energy efficient 12 watt LED lamp alongwith all accessories i/c S/F 1 No 7 watt LED lamp directly on wall connection etc as reqd.	Each	6		
69	SITC of designer hanging lights above conference table in the main conference room / hall of maximum size up to 750mm x 200mm x 200mm fabricated	Each	12		

S.No.	Item/Description	Unit	Qty	Unit price	Total Price
	out of fabric or glass on MS powder coated round or square bar frame fitted with CFL or LED bulbs as per design.				
70	SITC of Profile LED light fitting in 24mm x 26mm aluminium channels fitted with LED bulbs upto 100pc in each running meter length with SMPS of up to 120 watts max as required in wooden or POP false ceiling.	Mtr	60		
71	<b>Cable Tray</b>				
	Providing and fixing of GI cable tray with properly support complete with GI threaded.				
(a)	Cable Tray for copper piping (300 mm) without cover	RMT	20		
(b)	Cable Tray for copper piping (150 mm) without cover	RMT	20		
	<b>Details Of Audio Visual Equipment/Items</b>				
	<b>DISPLAY ITEMS</b>				
72	HD LED 75" Displays with wall mount(Samsung or equivalent make)	DM75E	01		
73	HD LED 55" Displays with swivel wall mount (Panasonic or equivalent make)	DC55E	04		
	<b>SWITCHING, INTERFACING SYSTEM, WIRELESS</b>				
74.	Wodden Podium with Logo(Custom or equivalent make)	-	01		
75.	Two-Input Wall plate Switcher for HDMI and VGA with Ethernet-Enabled HD Base T Output upto 70 M (Atlona or equivalent make)	AT-HDVS-150-TX-WP	01		
76.	HDBaseT Scaler with HDMI and Analog Audio Outputs(Atlona or equivalent make)	AT-HDVS-150-RX	01		
77.	2x8 HDMI to HDBaseT Distribution Amplifier with Extended Distance (Atlona or equivalent make)	AT-UHD-CAT-8	01		
78.	HDMI Over HDBaseT Receiver with Ethernet, RS-232, and IR (Atlona or equivalent make)	AT-UHD-EX-70C-RX	05		
79.	Wireless Collaboration Gateway with Required Accessories (Wepresent or equivalent make)	Wepresent	01		
80.	Three-input scaler for HDMI and VGA signals (Atlona or equivalent make)	AT-HD-SC-500	01		
	<b>AUDIO</b>				
81.	Wireless Control Unit (Bayerdynamic or equivalent make)	Quinta RS	01		

S.No.	Item/Description	Unit	Qty	Unit price	Total Price
82.	Delegate Microphones with Gooseneck Microphone 500mm/20" (Bayerdynamic or equivalent make)	Quinta MU 21+Classis GM 115 Q	05		
83.	Omnidirectional antenna for Quinta CU, triple-band 2,4/5,2 / 5,8 GHz, N(HF) female connector, for ceiling mounting with Antenna cable for Quinta, Cable with very low attenuation, N(HF) plugs, length 20 m (66 ft.) (Bayerdynamic or equivalent make)	CA Q14+CA Q 32	01		
84.	Single charger and power supply for Quinta (Bayerdynamic or equivalent make)	CA 2459	05		
85.	Two-way in-ceiling loudspeaker, 6.5" LF & 1" Tweeter, 80hm/60 Watts, 60Hz - 20KHz , White – PAIR (Apart or equivalent make)	CM608	08		
86.	Two Channel High Impedance Amplifiers – 100 Watts Per Channel (Crown or equivalent make)	XLS 1002	01		
87.	Wireless Handheld Microphone (AKG or equivalent make)	Perception Wireless Handheld	02		
88.	Wireless Lapel microphone (AKG or equivalent make)	Perception Wireless Handheld	01		
89.	Manual Mixer (Yamaha or equivalent make)	MG06	01		
	<b>CABLE, CONNECTORS</b>				
90.	VGA, HDMI Cable, Speaker Cable, Mic Cable, UTP Cable	Custom or equivalent make	L.S.		
91.	Equipment Rack	Indigenous or equivalent make	01		
92.	Installation , Commissioning, Documentation, Training	Webcon or equivalent make	01		
	<b>VRF AIRCONDITIONING SYSTEM</b>				
93.	<b>Installation of Variable Refrigerant Flow System</b>				
	Supply, Installation , Testing and commissioning of Modular type outdoor units equipped with highly efficient scroll compressors. Each outdoor unit should have minimum 1 no. variable compressor up to 18 HP, 2 nos. variable compressors upto 32 HP capacity, 3nos. variable compressors up to 54 HP				

S.No.	Item/Description	Unit	Qty	Unit price	Total Price
	capacity with special heat exchanger, 20- 27 Steps speed control DC motor condenser fan , auto check function for connection error, auto address setting and in built Double Stage Oil Separation to ensure minimum oil entrainment and proper lubrication.The condensing units should be capable for outside ambient 48 Deg. C.				
	24 HP Heat Pump Type- Top Discharge-100 % INVERTER	Nos	02		
94.	<b>INDOOR UNIT</b>				
	Supply , Installation , Testing and commissioning of Indoor units address setting and capacity as mentioned below. Multi-speed motor, coil section with DX coil, outer cabinet, drain pan mechanism insulation, pipe connections,etc of various capacities.				
	4 way cassette with wired/corded remote				
(a)	1.59TR/2.0 HP	Nos	03		
(b)	2.0 TR/2.5 HP	Nos	08		
(c)	2.65 TR/3.0 HP	Nos	03		
(d)	3.2 TR/4.0 HP	Nos	03		
95.	<b>Hi Wall Units</b>				
	1.5 HP	Nos	02		
96.	<b>Y-Joints</b>	Nos	20		
97.	Split 100% Cool only wall mounted Air - conditioners make Mitsubishi with maximum energy efficient i.e 5 or more star rating with complete fitting under buy back of old one split A.C. Complete installation with supportive low side work with no hidden cost				
(a)	1.8TR	Nos	01		



S.No.	Item/Description	Unit	Qty	Unit price	Total Price
(b)	1.5TR	Nos	01		
(c)	1.0 TR	Nos	01		
	<b>Airconditioning Systems other requirements for installations</b>				
98.	<b>Installation of Variabe Refrigerant Flow System - Setfree</b>				
	Installation Modular type Set free outdoor units equipped with highly efficient scroll compressors .Each outdoor unit should have minimum 1no.variable compressor variable compressors upto 48HP capacity with special heat exchanger, 27 Steps speed control DC motor condenser fan ,auto check function for connection error, auto address setting and in built Double Stage Oil Separation to ensure minimum oil entrachment and proper lubrication. The condensing units should be capable for outside ambient 48 Deg. C.				
99.	<b>Installation, Testing and Commissioning Outdoor Unit</b>				
	24 HP	Nos	2		
	<b>Indoor Units</b>				
	Installation, testing and commissioning of <b>SETFREE INDOOR</b> units , address setting and capacity as mentioned below. Multispeed motor, Coil Section with DX Coil, Outer Cabinet, drain pan mechanism insulation, pipe connections, fresh air intake connector and individually controlled louver setting for cassettes and concealed unit above 3 HP having higher air quantity of 400 CFM/tr etc. of various capacities as per OEM (Hitachi) specifications.				
100.	<b>Cassette Units</b>				
(a)	1.59TR/2.0 HP	Nos	3		

S.No.	Item/Description	Unit	Qty	Unit price	Total Price
(b)	2.0 TR/2.5 HP	Nos	8		
(c)	2.65TR/3.0 HP	Nos	3		
(d)	3.2 TR/ 4.0 HP	Nos	3		
101.	<b>Hi-Wall Units</b>				
(a)	Wall Mounted Split Type : 1.5 HP	Nos	2		
(b)	Corded Remote	Nos	20		
(c)	MS Stand for Outdoor Unit Mounting	Nos	2		
102.	<b>Refrigerant Piping, Drain Piping and Cabling</b>				
	Supply installation testing and commissioning of Interconnecting refrigerant pipe work with (19mm/13 mm thick) closed cell elastomeric nitrile rubber tubular insulation between each set of indoor & outdoor units as per HITACHI STD & specifications, all piping inside the room shall be properly supported with MS hanger.				
(a)	41.3 ( with 19 mm Insulation )	RMT	59		
(b)	34.9 ( with 19 mm Insulation )	RMT	65		
(c)	28.6 ( with 19 mm Insulation )	RMT	59		
(d)	22.2 ( with 19 mm Insulation )	RMT	65		
(e)	19.1 ( with 19 mm Insulation )	RMT	55		
(f)	15.9 ( with 19 mm Insulation )	RMT	95		
(g)	12.7 ( with 19 mm Insulation )	RMT	49		
(h)	9.5 ( with 19 mm Insulation )	RMT	95		
(i)	6.4 ( with 19 mm Insulation )	RMT	55		
	<b>Cable Tray</b>				
103.	Providing and fixing of GI cable tray with properly support complete with GI threaded.				

S.No.	Item/Description	Unit	Qty	Unit price	Total Price
(a)	Cable Tray for copper piping (300 mm) without cover	RMT	20		
(b)	Cable Tray for copper piping (150 mm) without cover	RMT	20		
104.	<b>Supply, installation, testing &amp; commissioning of Refnet Joints</b>	Nos.	20		
105.	Providing and fixing rigid PVC piping complete with fittings, supports as per HITACHI Standards & specifications and duly insulated with 6 mm thick closed cell nitrile rubber insulation.				
(a)	32 mm dia	RMT	76		
(b)	40mm dia	RMT	35		
106.	Supply & fixing of control cum transmission wiring of Copper Conductor Cable alongwith Conduite for looping between indoor & outdoor VRF System & to main Central remote controller system				
(a)	2 C X .75 Sq mm	RMT	350		
107.	Cassette Frames – Welding	Nos.	20		
	<b>Fire Alarm System</b>				
108.	Supplying and fixing of following sizes of steel conduit along with accessories in surface/recess including painting in case of surface conduit or cutting the wall and making good the same in case of recessed conduit as required				
(a)	(c) 20 mm	Mtr	50		
(b)	(d) 25 mm	Mtr	100		
109.	Supplying and drawing following sizesx of FRLS PVC insulated copper conductor, single core cable in the existing surface/recessed steel/PVC conduit as required				
(a)	2 x 1.5 sq. mm	Mtr	500		

S.No.	Item/Description	Unit	Qty	Unit price	Total Price
110.	Supplying, installation, testing and commissioning of Analog Addressable Fire Alarm Control Panel (FACP) with battery charger and battery back up for 8 hours normal operation and one hour alarm operation. The FACP shall include a full featured operator interface control and annunciation panel that shall include a backlit 640-character liquid crystal display, and a QWERTY style alphanumeric keypad for the field programming and control of the fire alarm system. The panel should be equipped with sufficient numbers of loop with 20% spare capacity with each loop shall have a capacity of minimum 159 detectors and 159 modules in one loop. The panel shall be UL listed and FM approved and comply UL 864, 9th Edition requirement. The enclosure shall also be UL listed. The quoted rate shall include supply of necessary software and hardware for programming the panel with all necessary licence.	Nos.	11		
111.	Supply, installation, testing & commissioning of Analogue addressable Photo Electric type Smoke Detector with mounting base, address switch complete as required.	Nos.	75		
112.	Analogue addressable rate of rise cum fixed temperature, thermistor type heat detector with mounting base, address switch complete as required.	Nos.	02		
113.	Addressable Hooter (sound output of minimum 90 db ) cum strobe(strength of light 10 cd) with control module complete as required.	Nos.	02		
114.	Supply, fixing, testing and commissioning of flush type response indicator with red coloured neon lamp.	Nos.	70		
115.	Supplying, fixing, testing and commissioning of Addressable Manual	Nos.	02		

S.No.	Item/Description	Unit	Qty	Unit price	Total Price
	Call Point complete with address switch. ( Not Break Glass units)				
116.	Supplying, fixing, testing and commissioning of Addressable control / relay modules for shutting down, AHUs, activation of Smoke exhaust fans, elevator recall etc.	Nos.	02		
117.	Supplying, fixing, testing and commissioning of Addressable monitor module for connecting to Flow Switch /Tamper switches of sprinkler and water supply control valves etc.	Nos.	02		
118.	Supply, installation, testing and commissioning of smart board of suitable size complete with all accessories including projector, desktop computer, speaker and all relevant accessories etc. as required	Nos.	01		
119.	Supplying and fixing of following ways surface/recess mounting, vertical type, 415V, TPN MCB distribution board of sheet steel, dust protected, duly powder painted, inclusive of 200A, tinned copper bus bar, common neutral link, earth bar, din bar for mounting MCBs (but without MCBs and incomer) as required. (Note : Vertical type MCB TPDB is normally used where 3 phase outlets are required.)				
(a)	8 way (4+24), Double door	Nos	02		
(b)	12 way (4+36), Double door	Nos	02		
120.	Supplying and fixing following rating, four pole 415 V, isolator in the existing MCB DB complete with connections, testing and commissioning etc. as required.				
(a)	63A	Nos	02		
(b)	100A	Nos	02		
121.	Supplying and fixing 5A to 32A rating, 240/415V, 10Ka, "C" Curve, miniature				

S.No.	Item/Description	Unit	Qty	Unit price	Total Price
	circuit breaker suitable for inductive load of following poles in the existing MCB DB complete with connections, testing and commissioning etc. as required.				
	Single pole	Nos	60		
122.	Earthing with G.I. earth plate 600 mm x 600 mm x 6 mm thick including accessories, and providing masonry enclosure with cover plate having locking arrangement and watering pipe of 2.7 meter long etc. (but without charcoal/coke and salt) as required	Set	04		
123.	Extra for providing charcoal and salt of required quantity	Set	04		
124.	Providing and fixing 25 mm x 5 mm G.I. strip in 40 mm G.I. pipe	Mtr	60		
125.	Providing and laying of 6 mm G.I. wire on surface or on recess for loop earthing as required	Mtr	60		
126.	Supplying of 01 No. PVC insulated and PVC sheathed/XLPE power cable of 1.1 kV grade of following size				
(a)	(c) 3.5 x 70 sq. mm	Mtr	50		
(b)	(d) 2 x 10 sq. mm	Mtr	500		
127.	Laying of one number PVC insulated and PVC sheathed/XLPE power cable of 1.1 kV grade of following size in the existing RCC/HUME/METAL pipe etc. as required				
(a)	Upto 35 sq. mm	Mtr	100		
(b)	Above 35 sq. mm and upto 95 sq. mm	Mtr	10		
128.	Laying and fixing of one number PVC insulated and PVC sheathed/XLPE power cable of 1.1 kV grade of following size on wall surface as required				

S.No.	Item/Description	Unit	Qty	Unit price	Total Price
(a)	Upto 25 sq. mm	Mtr	400		
(b)	Above 25 sq. mm and upto 120 sq. mm`	Mtr	90		
129.	Supplying and making end termination with brass compression gland and aluminium lugs for following size of PVC insulated and PVC sheathed/ XLPE aluminium conductor cable of 1.1 kV grade as required				
(a)	2 x 10 sq. mm	Nos	60		
(b)	2 x 70 sq. mm	Nos	02		
130.	VRF Hitachi Air Conditioning System using Cassette Type Indoor Units for Air Flow/Circulation as per specification given in RFP	CAMC for 03 <sup>rd</sup> year			
131.		CAMC for 04 <sup>th</sup> year			
132.		CAMC for 05 <sup>th</sup> year			
Grand Total					

**Note1:**

- (a) The financial bid has to be filled necessarily in the format given above and has to be signed by the authorized representative of the bidder with full name designation and seal on each page. The above quote should include Clearing and Transportation charges.
- (b) Price quoted should be valid for minimum 06 months from the last date of submission of the bids.
- (c) Explanatory notes, if so desired, can be separately submitted along with the financial bid but financial bid in the above format is required to be submitted.
- (d) Equipment delivery time will be 90 days from the date of issue of Supply order.
- (e) Please indicate separately any duties, taxes.

**Note 2 :** The rate may be quoted in foreign currency and/or in Indian currency, however, for comparison/evaluation purpose the bills selling market rate of exchange established by RBI for similar transaction as on date of opening of price bid shall be used to convert foreign currencies to the Indian rupees.

**Note 3 :** Determination of L-1 will be done based on Grand Total (not including levies, taxes and duties levied by Central/State/Local governments such as excise duty, GST, Octroi/entry tax, etc. on final product) of all items/requirements as mentioned above.

**SIGNATURE OF BIDDER WITH SEAL AND DATE**



## Performance Security

### FORM OF BANK GUARANTEE FOR PERFORMANCE SECURITY

(To be stamped in accordance with Stamps Act of India)

1. THIS DEED of Guarantee made this day of \_\_\_\_\_ between \_\_\_\_\_ (Name of the Bank) (here in after called the "Bank") of the one part and \_\_\_\_\_ (Name of the Department) (hereinafter called the "Department") of the other part.
2. WHEREAS \_\_\_\_\_ (Name of the Department) has awarded the contract for creation of International Training Centre with complete Interior works, supply & installation of Furniture/Fixtures, Audio/Visuals Equipment/Items and VRF Air-conditioning System all Complete ready to use on turnkey basis at 2<sup>nd</sup> floor, Pilot Test House located in E-3, MIDC Area, Adheri (E), Mumbai with allied misc jobs for Rs. \_\_\_\_\_ (Rupees in figures and words) (hereinafter called the "contract") to M/s \_\_\_\_\_ (Name of the contractor (hereinafter called the "contractor")).
3. AND WHEREAS THE Contractor is bound by the said Contract to submit to the Department a Performance Security for a total amount of Rs. \_\_\_\_\_ (Amount in figures and words).
4. NOW WE the Undersigned \_\_\_\_\_ (Name of the Bank) being fully authorized to sign and to incur obligations for and on behalf of and in the name of \_\_\_\_\_ (Full name of Bank), hereby declare that the said Bank will guarantee the Department the full amount of Rs. \_\_\_\_\_ (Amount in figures and words) as stated above.
5. After the Contractor has signed the aforementioned contract with the Department, the Bank is engaged to pay the Department, any amount up to and inclusive of the aforementioned full amount upon written order from the Department to indemnify the Department for any liability of damage resulting from any defects or shortcomings of the Contractor or the debts he may have incurred to any parties involved in the Works under the Contract mentioned above, whether these defects or shortcomings or debts are actual or estimated or expected. The bank will deliver the money required by the Department immediately on demand without delay without reference to the Contractor and without the necessity of a previous notice of or judicial or administrative procedures and without it being necessary to prove to the Bank the liability of damages resulting from any defects or shortcomings or debts of the Contractor. The bank shall pay to the Department any money so demanded notwithstanding any dispute /disputes raised by the Contractor in any suit of proceedings pending before any Court, Tribunal or Arbitrator(s) relating thereto and the liability under this guarantee shall be absolute and unequivocal.
6. THIS GUARANTEE is valid for a period of \_\_\_\_\_ months from the date of signing. (The initial period for which this Guarantee will be valid must be for at least six months longer than the anticipated expiry date of the Contract period).
7. At any time during the period in which this Guarantee is still valid, if the Department agree to grant a time of extension to the contractor or if the contractor fails to complete the works within the time of completion as stated in the contract, or fails to discharge himself of the liability or damage or debts as stated above, it is understood that the Bank will extend this Guarantee under the same conditions for the required time on demand by the Department and at the cost of the contractor.

8. The Guarantee hereinbefore contained shall not be affected by any change in the Constitution of the Bank of the contractor.
9. The Neglect of forbearance of the Department in enforcement of payment of any moneys, the payment where of is intended to be hereby secured or the given of time by the Department for the payment hereof shall in no way relieve the Bank of their liability under this deed.
10. The expressions "the Department", "the Bank" and "the Contractor" herein before used shall include their respective successor and assigns.

IN WITNESS whereof I/We of; the bank has signed and sealed this guarantee on the \_\_\_\_\_ day of \_\_\_\_\_ (Month) \_\_\_\_\_ (Year) being herewith duly authorized.

For and on behalf of  
the \_\_\_\_\_ Bank.

Signature of authorized Bank official

Name \_\_\_\_\_

Designation \_\_\_\_\_

I.D. No. \_\_\_\_\_

Stamp/ Seal of the Bank.

Signed, sealed and delivered for and on behalf of the Bank by the above named  
\_\_\_\_\_ in the presence of :

Witness- 1

Signature \_\_\_\_\_

Name \_\_\_\_\_

Address \_\_\_\_\_

Witness- 2

Signature \_\_\_\_\_

Name \_\_\_\_\_

Address \_\_\_\_\_

**Tender Form**

To,

The Assistant Director (QA)  
Food Safety and Standard Authority of India  
Ministry of Health & Family elfare,  
FDA Bhawan, Kotla Road,  
New Delhi-110002

Ref.Your Tender No. \_\_\_\_\_ dated \_\_\_\_\_

We, the undersigned have examined the above Tender Document, No. \_\_\_\_\_, dated \_\_\_\_\_(if any), (*description of the goods and services*) in conformity with your above referred document.

If our Tender is accepted, we undertake to perform the services as mentioned above.

We agree to keep our tender valid for acceptance as required in the Tender document or for subsequently extended period, if any agreed to by us. We also accordingly confirm to abide by this Tender up to the aforesaid period and this Tender may be accepted any time before the expiry of the aforesaid period. We further confirm that, until a formal contract is executed, this Tender read with your written acceptance thereof within the aforesaid period shall constitute a binding contract between us.

We further understand that you are not bound to accept the lowest or any tender you may receive against your above-referred Tender enquiry.

We confirm that we do not stand deregistered/banned/blacklisted by any Central/State Government Departments/offices.

Brief of court/legal cases pending, if any, are following:

We confirm that we fully agree to the terms and conditions specified in above mentioned Tender documents, including amendment/ corrigendum if any.

(Signature with date)

(Name and designation)

Duly authorised to sign Tender for and on behalf of bidder  
with company seal

## BIDDER'S PROFILE

1.	Name of firm:	
2.	Bidder's name	
3.	Registered office address	
4.	Correspondence address	
5.	Telephone: Office – Residence Mobile No.	
6.	E-mail address & website	
7.	Tele-fax Number	
8.	VAT No.	
9.	PAN Number	
10.	The applicant is a proprietary / partnership firm / Limited Company  (Please attach attested copies of documents of registration / incorporation of your firm)	
11.	The applicant is registered with CPWD / PWD/ or any Government Organizations for undertaking the construction / civil work (Please attach attested copies of documents)	

I / We hereby declare that the information furnished above is true and correct.

Place:

Date:

Signature of Bidder / Authorized signatory .....  
Name of the Bidder .....

(Seal of the Bidder)

## FINANCIAL STATUS

Name of the Bidder \_\_\_\_\_

Description	Financial Years		
	2015-16	2016-17	2017-18
Annual Turnover			
Net Worth			
Current Assets			
Current Liabilities			
Total Revenues			
Profit Before Tax			
Profit After Tax			

1. Attach the copies of financial statements, duly certified, including all related notes and income statement for the last three Financial Years as indicated above complying with the following conditions.
2. All such documents reflect the financial situation of the bidder and not sister or parent companies.

**SIGNATURE OF THE BIDDER WITH SEAL AND DATE**

**LETTER OF AUTHORITY**

PROFORMA FOR LETTER OF AUTHORITY FOR ATTENDING MEETING.

No.

Date:

The Assistant Director (QA)  
FDA Bhawan, 3<sup>rd</sup> floor,  
Kotla Road,  
New Delhi-110002

Dear Sir,

We \_\_\_\_\_ hereby authorize following representative(s) to attend Technical bid opening & Price bid opening and for any other correspondence and communication against above Bid Document:

1) Name & Designation \_\_\_\_\_ Signature

2) Name & Designation \_\_\_\_\_ Signature

We confirm that we shall be bound by all commitments made by aforementioned authorised representatives.

Yours faithfully,

Signature

Name & Designation

For and on behalf of

Note: This letter of authority should be issued by the bidder in writing & duly signed by a person competent and having the power of attorney to bind the bidder. Not more than two persons are permitted to attend Techno -commercial un-priced and Price bid opening.

THE LIST OF PREFERRED MAKES OF MATERIALS		
1	POLY-SULPHIDE/SILICON SEALANT	PIDILITE,TUFFSEAL,CHOKSEY CHEMICALS,FOS ROC
2	WHITE CEMENT	J.K. WHITE, BIRLA WHITE,
3	WATER PROOFING COMPOUND	ACCOPROOF,IMPERMO,PIDILITE,CICO,FOSROC,CHOKSEY
4	BITUMEN	INDIAN OIL, HINDUSTAN PETROLEUM
5	NON METALIC SURFACE HARDNER	MC DERITOP F.H
6	LOCKS/LATCH	GODREJ,HARRISION,PLAZA, GOLDEN,YALE
7	WIRE MESH	STERLING ENTERPRISES,TRIMURTY WELDED MESH,TIGER, SELECTED PRODUCT Co.
8	PRELAMINATED PARTICLE BOARD	CENTURY PLY, NOVOPAN, KITLAM, ECO, BOARD, DURO, KITPLY, NATIONAL
9	ADHESIVE	PIDILITE, SIKA,THERMOSHIELD,DUNLOP,VAMORGANIC
10	DASH FASTNERS	HILTI, FISCHER,BOSCH,CANON
11	HYDRAULIC DOOR CLOSER/FLOOR SPRING	HARDWYN,GODREJ,YALE
12	S.S.STAIRCASE RAILING	JINDAL STAINLESS STEEL LTD., ICICH INDUSTRIES,ESSAL
13	FLOAT GLASS	MODI FLOAT, SAINT GOBAIN, ASAHI,
14	NUTS,BOLTS AND SCREWS,STEEL	KUNDAN,PRIYA,ATUL,PUJA
15	EPDM GASKET	HANU/ANAND/LESCUYER
16	PREMIUM ACRYLIC SMOOTH EXTERIOR PAINT	ASIAN PAINTS(APEX ULTIMA),BERGER(WEATHER COAT ALL GUARD),I.C.I. DULUX(WEATHER SHIELD MAX)
17	ACRYLIC SMOOTH EXTERIOR PAINT	ASIAN PAINTS(APEX PREMIUM EMULSION), BERGER PAINTS (WEATHER COAT SMOOTH EMULSION), I.C.I. DULUX (WEATHER SHIELD PREMIUM EMULSION)
18	CERAMIC GLAZED TILES	JOHNSON,KAJARIA,BELL CERAMICS,NITCO,SOMANY, ASIAN GRANITO INDIA LTD
19	PORCELAIN TILES	ASIAN,CENTURY,JOHNSON



20	VITRIFIED TILES	ASIAN GRANITO INDIA LTD, KAJARIA,BELL CERAMICS,NITCO,SOMANY
21	TILES ADHESIVE	HOME PRIDE,CICO,UNITILE,FERROUS,TILEMATE
22	CHEQUURED TILE	NITCO,MODERN,ULTRA,UNISTONE
23	CC PAVERS	NITCO,BHARAT REGENCY,HINDUSTAN,ULTRA, DURACRETE K.K.
24	GRASS PAVER	UNISTONE,ULTRA,HINDUSTAN,K.K.
25	WATER PROOFING CEMENT PAINT	ASIAN,SUPPER SNOWCEM,
26	LAMINATES	ARGO LAM, MARINO, CENTURY, FORMICA
27	PLASTIC EMULSION PAINT	ASIAN,BERGER,NAROLAC
28	WC/WASH BASIN & OTHER VITREOUS CHINA SAINITARYWARE	PARRYWARE,HINDWARE,CERA,NYCER,SOMANY
29	FIRECLAY SINKS & DRAIN BOARDS	PARRY,SANFIRE(DELUXE)
30	STAINLESS STEEL SINKS	NILKANTH,NIRALI,COBRA,ALEX,JAYNA, SELECTED PRODUCT Co.
31	C.P.BRASS FITTINGS	JAGUAR(CONTINENTAL), KINGSTON(ELTA), PARKO(VIC),(ISI), PRAYAG(ISI) & PRIMA(ISI) (HEAVY)
32	SOIL,WASTE & VENT PIPES & FITTINGS  A) CENTRFUGAL CAST IRON	NEECO,HEPCO,SKF
33	LA (CI) PIPES	RIF, NEECO
34	G.I. SHEET	SAIL, TATA
35	FIBRE GLASS SHEET	SIMCRYL,SIMBA
36	G.I. PIPES	TATA,JINIDAL (HISSAR)
37	G.I. FITTINGS (MALLAEABLE CAST IRON)	UNIK, ICS,AMCO,KS,NVR
38	GUNMETAL VALVES	LEADER,SANT,ZOLOTO
39	STONEWARE PIPE & GULLY TRAPES	PERFECT,PARRY
40	R.C.C. PIPES (NP-2)	LAKSHMI,SOOD & SOOD,JAIN & CO, DIWAN SPUN PIPES

41	C.I. DOUBLE FLANGER SLUICE VALVES	KIRLOSKAR, IVC, BURN
42	C.I. DOUBLE FLANGED NON-RETURN VALVES	KIRLOSKAR, SANT,KARTAR
43	C.I. MANHOLES COVERS AND FRAME	B.C.M RIF,NEECO
44	UPVC PIPE	SUPREME, PRINCE,FINOLEX, PRAKASH
45	BALL VALES	ZOLOTO,IBP,ARCO
46	GLASS PANS	SAINT GOBAIN, ASAHI INDIA,MODIGUARD
47	MIRROR	ATUL, MODIGUARD
48	READY MIX CONCRETE (RMC)	LAFARGE,ALCHON/ACC/L&T/GRASIM/ULTRATECH
49	UPVC WINDOW/DOORS	FENESTA,REHAU,POLYWOOD
50	PPR PIPES	SFMC,SAFE,POINEER INDUSTRIES
51	FIRE GLASS FOR VISION PANNELS	SAINT GOBAIN, ASHAI INDIA,MODI
52	TEXTURE FINISH	SPECTRUM,ACRO,SANDTEX,REVLONTEX
53	ALUMINIUM EXTRUDED PROFILES	HINDALCO/JINDAL/NALCO/MHAHVIR
54	FIRE DOOR	GODREJ/SHAKTI/NAVAIR, JAIN DOORS PVT. LTD.
55	PT MT	PRYAG,POLYUF
56	ROLLING SHUTTER	RAMA ROLLING SHUTTER,JYOTI ROLLING SHUTTER, ANAND INDUSTRIES
57	CPVC PIPE & FITTINGS	AJAY FOLOWGUARD,ASHIRWAD FOLOGUARD, PRAYAG DURALIFE.
58	POP (PLASTER OF PARIS)	J K. LAXMI,SRIRAM NIRMAN,TRIMURTI
59	BLOCK BOARD	CENTURY PLY BOARD,NATIONAL PLYWOOD, KITPLY, JAYNA, DURO
60	FLUSH DOOR	DURO,DOOR KING,CENTURY, GREENPLY, JAIN DOORS PVT. LTD.
61	FRP CHAJJA & DOORS	FIBERWAYS,FIBRE ENINGEER,,ASHOO, FIBRE TECHNO PRODUCTS, SELECTED PRODUCT Co., JAIN DOORS PVT. LTD.
62	PVC DOORS	RAJSHREE,FINOLEX PLASTICS

63	SFRC/PRECAST C.C. COVERS	KK MANHOLE,NITCO,DALAL
64	PRECAST CC INTERLOCKING TILES	HINDUSTAN, DALAL, PAVER INDIA, K.K.
65	PVC WATER STORAGE TANK	SINTEX,POLYCON, SHEETAL, SPL
66	KITCHEN LOFT TANK	SINTEX
67	PRECAST CC KERB STONE	DALAL,PAVER INDIA, K.K.,NITCO,HINDUSTAN
68	WHITE CEMENT BASED PUTTY	BIRLA, J.K.
69	DUCTILE IRON PIPE (WATER SUPPLY)	ELECTRO STEEL, KESSO,KDUPL, ELECTRO SPUN
70	FACTORY MADE SECTION WINDOW	ISI MARK PRODUCT ONLY,
71	PLASTIC WC SEAT COVER	COMMANDER,JINDAL,ADMIRAL,CUCKOO
72	PVC CISTERN	STEELBIRD,JINDAL,SEABIRD,PARRYWARE,HINDWARE
73	M.S. DOOR FITTINGS	ASHISH,OXFORD,GARG,ADARSH
74	ALUMINIUM DOOR FITTINGS	CLASSIC,EVEREST,ARGENT
75	FIRE PROOF DOORS	VIPER,SUKURI,SIGNUM,GODREJ,NAVAIR, JAIN DOORS PVT. LTD.
76	SYNTHETIC ENAMEL PAINTS	APCOLITE GLOSS ENAMEL OF ASIAN PAINTS, LUXOL HI-GLOSS ENAMEL OF BERGER PAINTS, DULUX HI-GLOSS ENAMEL PAINT OF ICI (DULUX)
77	DISTEMPER & PRIMER	ICI(DULUX), BERGER, ASIAN PAINT
78	CONSTRUCTION/REPAIR CHEMICALS	PIDILITE, CHOKSEY, FOSROC, CICO